

# Multimedia Partner in Your Hand!

High-Brightness, Large-Screen Projector with Smart, Speedy Operation Packed in Such a Small Body for Applications Ranging from Business to Entertainment

Lightweight &  
**SMALL**  
Design

Super Compact Design

Advanced Mobile Projector Modeling

## Super Compact Size for Uses Ranging from Business to Entertainment

With dimensions of only 247mm (W) x 64mm (H) x 122mm (D)\* and a 1.45kg lightweight body, the XR-1X/S is easily carried in one hand and fits right into even a small briefcase with a mobile PC, greatly helping your business presentations on the go. Also, it flexibly provides multimedia entertainment by connection with a variety of digital equipment. In addition, the flat top and back face designed in such a compact book style is conveniently stored, providing an attractive, sleek appearance. The XR-1X/S is a cutting edge multimedia projector as a digital tool.

\* Main body only

## DLP™ Technology for High Contrast and Compactness

The DLP optical system dramatically reduces optics size, achieving an amazingly slim and compact body. It also prevents light leakage compared with LCD projection, providing sharper blacks in black parts and a higher contrast ratio in this size of projector.

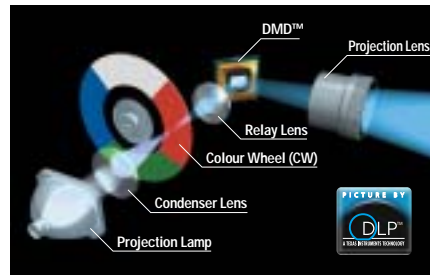

## Built-in Carl Zeiss Optical Module

With a high-quality, high-performance Carl Zeiss Optical Module, which has an esteemed reputation among camera lens systems, the projector provides high performance even from its compact body.



Intuitive and  
**SPEEDY**  
Setup

Speedy Presentations Possible for All Users

Quickly Leads You through Projector Setup

## Quick Start and Quick Shutdown for Speedy Presentations from Start to Finish

On the XR-1X/S, height adjustment can be set up with only one hand. It takes only approx. 3 seconds to project the image, and a remarkably short time to cool down, almost half as short as conventional models, achieving an amazingly short time to start and finish projection.

- Auto Sync automatically synchronises Phase, Clock, H-Pos, V-Pos and Automatic Keystone Correction for quick and speedy projection settings.

### Speedy Setup

One!

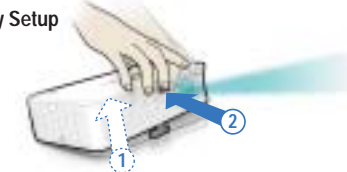

Adjust the height with one hand.

Two!



Automatically get a rectangular image.

Start!

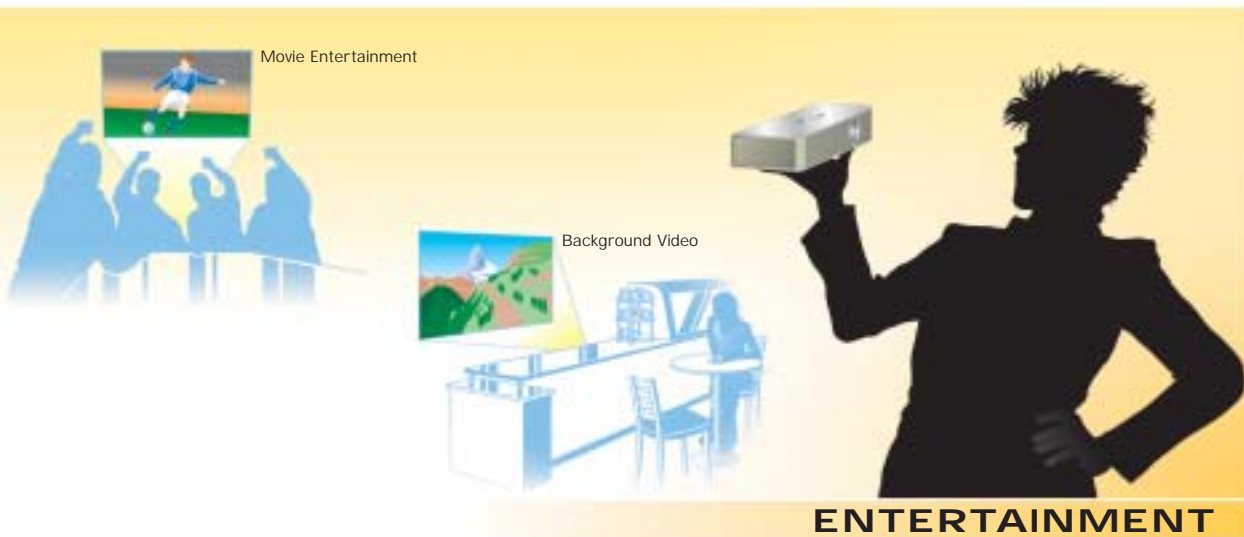

SMART  
Operation

Interactively Supports Your Performance like a Partner

A Variety of Guide Functions Lead You through Easy Operation

## Setup Guide for Interactive Operation Using Intuitive OSD Images and Highly Informative Illuminating Guide LEDs.

XR-1X/S's Setup Guide provides intuitive OSD images and Guide LEDs to show the next step interactively for setup including focus, zoom and height adjustment. Plus, the beeping sounds inform you when the power is on and cooling down is over.

### Setup Guides



Setup guides is displayed after the projector is turned on.

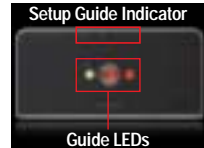

Guide LEDs illuminate to inform you of the button location even in a dark room.

## Interactive Help Menu

When you have trouble with operation, the Help Menu displays the trouble and assists you with the solution.



LOW COST  
Performance

## 4,000 Hour Long Lamp Life

The XR-1X/S achieves a long 4,000 hours of lamp life in Eco Mode (3,000 hours in Standard Mode), quite long in this size of pico-portable projectors.

## Highly Sealed Optics

The optical mechanism of DLP™ system projectors is sealed in its structure, preventing dust, dirt and smoke from entering core parts of the optics to a much greater degree than with LCD projectors. This enables longer use and reduction of maintenance costs.

### Sealed Optics

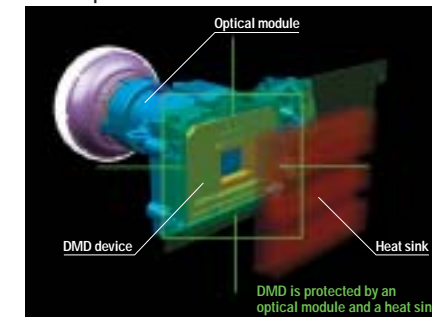

## Other Outstanding Features

- 4:3 and 16:9 Aspect Ratios and DTV/HDTV and DVD Compatible (480i, 480P, 540P, 540i, 580P, 720P, 1035i and 1080i)
- Image Shift Function  
Images projected in 16:9 can be vertically shifted for better viewing in a limited place.
- Enhanced Three-Two Pull Down for NTSC and Two-Two Pull Down for PAL
- Colour Temperature Adjustment
- Excellent PC Compatibility:  
XGA (1,024 x 768) (XR-1X) and SVGA (XR-1S) truly compatible SXGA+ (1,400 x 1050) and SXGA (1,280 x 1024) compatible in intelligent compression
- Credit-Card Size Remote Control with Mouse Control
- Presentation Support: Freeze, AV Mute
- Theft Deterrent Function "System Lock"
- Soft Case with Remote Control Pocket and Cable Band

## Correlation of XR-1X/S to Screen

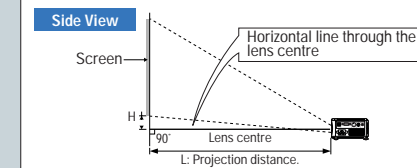

### Screen Size and Projection Distance

Diag. (inches)	Picture size		Projection distance (L)		Distance from the bottom of the image to the lens centre (H)
	Width (cm)	Height (cm)	Minimum	Maximum	
270	549	411	9.9m	4.3m	-50.9cm
100	203	152	3.7m	4.3m	-18.9cm
60	122	91	2.2m	2.6m	-11.3cm
30	61	46	1.1m	1.3m	-5.7cm

Diag. (inches)	Picture size		Projection distance (L)		Distance from the bottom of the image to the lens centre (H)	Adjustable range of image position (S)
	Width (cm)	Height (cm)	Minimum	Maximum		
250	553	311	10.0m	4.6m	-103.2cm	±51.9cm
100	221	125	4.0m	4.6m	-41.3cm	±20.8cm
60	133	75	2.4m	2.8m	-24.8cm	±12.5cm
30	66	37	1.2m	1.4m	-12.4cm	±6.2cm

Diag. (inches)	Picture size		Projection distance (L)		Distance from the bottom of the image to the lens centre (H)	Adjustable range of image position (S)
	Width (cm)	Height (cm)	Minimum	Maximum		
280	569	427	9.8m	4.1m	-61.5cm	±51.9cm
100	203	152	3.5m	4.1m	-22.0cm	±20.8cm
60	122	91	2.1m	2.4m	-13.2cm	±12.5cm
30	61	46	1.1m	1.2m	-6.6cm	±6.2cm

Diag. (inches)	Picture size		Projection distance (L)		Distance from the bottom of the image to the lens centre (H)	Adjustable range of image position (S)
	Width (cm)	Height (cm)	Minimum	Maximum		
260	576	324	9.9m	4.4m	-116.2cm	±54.0cm
100	221	125	3.8m	4.4m	-44.7cm	±20.8cm
60	133	75	2.3m	2.7m	-26.8cm	±12.5cm
30	66	37	1.1m	1.3m	-13.4cm	±6.2cm

\* Negative figures mean the lens centre position is under the bottom of the picture.  
\* There may be an error of ±3% in the above values.

## Dimensions (XR-1X/S)

