

# SHARP®

사용 설명서



모델

# XG-NV7XM

디지털 멀티미디어  
프로젝터

**Notevision**  
SLIM & COMPACT PROJECTOR





10

“ ”

: XG-NV7XM

:

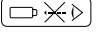
: 

가

:

:

가



- 1. 가 / 가
- 2. 가
- 3. 가
- 4. ( : , , ) .
- 5. 가 가
- 6. —
- 7. 가  가
- 8. 가
- 9. ( )
- 10. 가
- 11. 가
- 12.
- 13.
- 14. 가
- 15.
- 16. 가
- 17. 가 가
  - a. 가
  - b. 가
  - c. 가
  - d. 가
- 18. 가가
  - e. 가
  - f. 가
- 19. 가 가
  - a. -
  - b. -



1. (PanelLink™)

2. PC  
200Hz . ( 11 )

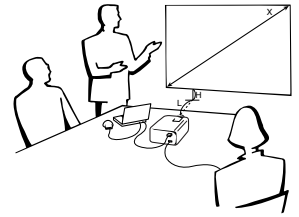

3. DTV\*/HDTV  
DTV 가가 . ( 13 ) DTV 16:9

4. (VIA RGB)  
DTV , DVD . ( 13 )

가

5.  
6. 가 . ( 19 )

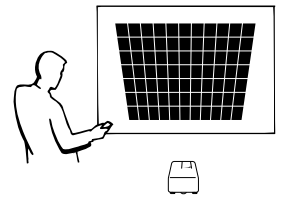

7. (GUI) . ( 23 )

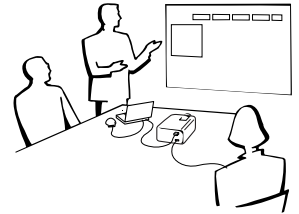

8. (GUI) 2

9. IrCOM  
IrCOM 가 . ( 25 ) PC

10. . ( 29 )

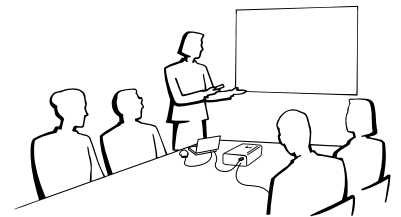

11. ( 36 )

12. XGA (1,024 × 768)

13. UXGA  
UXGA (1,600 × 1,200) 1,024 × 768

14. 가 가 ( : ) . ( 42 )

15. " , " , " " 가 . ( 44 ) "

16.

\*DTV



.....	2
.....	3
.....	4
.....	5
<b>PDF</b>	
(Windows & Macintosh) .....	6
.....	7



.....	10
.....	11
.....	16
.....	18
.....	21
<b>GUI (Graphical User Interface)</b>	
.....	23
<b>IrCOM</b> .....	25
.....	26
(            ) .....	26
.....	27
.....	28
.....	29
.....	30
.....	30
.....	31
.....	32

.....	33
.....	34
.....	35
.....	36
.....	37
.....	37
.....	38
<b>I/P</b> .....	39
.....	39
.....	40
.....	40
.....	41
.....	42
.....	43
.....	44
.....	45



.....	47
.....	48
<b>A/S</b> .....	48
.....	50
.....	51
<b>RS-232C</b> .....	52
(            ) .....	54
.....	56
.....	57
.....	58
.....	62
.....	63

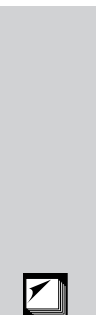
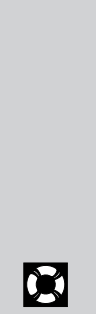
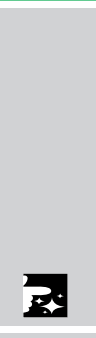



LASER RADIATION DO NOT STARE INTO BEAM CLASS 2 LASER PRODUCT	RADIACION LASER NO MIRE AL RAYO PRODUCTO LASER CLASE 2
RAYONNEMENT LASER NE PAS REGARDER DANS LE FAISCEAU APPAREIL A LASER DE CLASSE 2	
Class II	LASERSTRAHLUNG NICHT IN DEN STRAHL DER LASERVORRICHTUNG DER KLASSE II BLICKEN
LAR LASERSTR LEN TITTA INTE IN I LASERSTR KLASS 2 LASER PRODUKT.	LASERSÄTEIVÄ ÄLÄKÄTÄSO SOURAAN SÄTEESEEN LUOKAN 2 LASERTUOTE
LASEROVÉ ZÁŘENÍ NEHLEDTE DO PAPRSKU LASEROVÝ VÝROBEK TŘIDY 2	LASEROVÉ ŽIARENIE NEPOZERAJTE SA DO LÚČA LASEROVÝ VÝROBOK TRIEDY 2

Class II

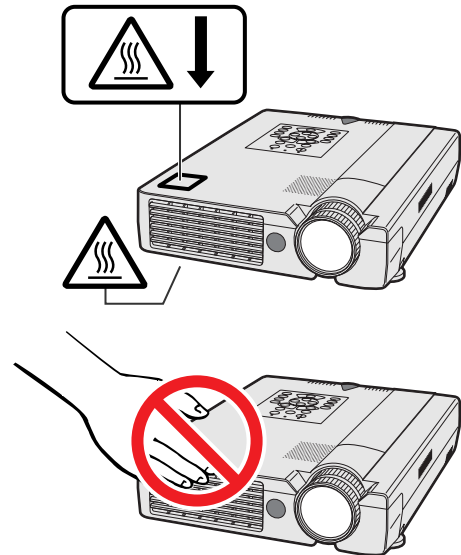
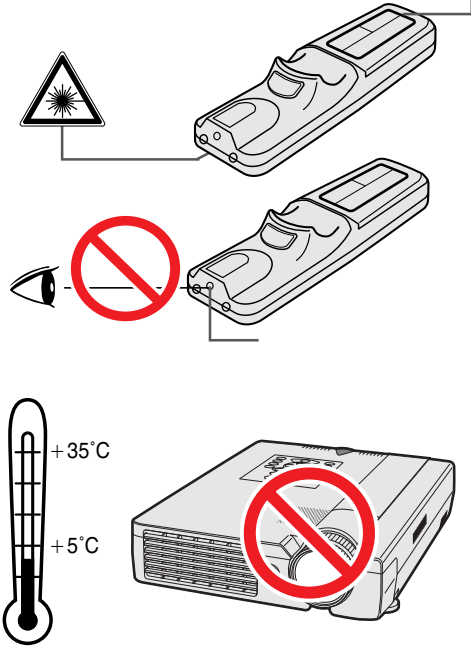

가 ( )  
+5°C 35°C

가 ( )  
가 LCD

가 가  
( ) 10cm  
ON 10

가 “ ” “X” 가 가  
47 90 “ /

주



PDF PC Adobe Acrobat Reader CD-ROM 가 Adobe Acrobat Reader  
 CD-ROM (http://www.adobe.com)

**CD-ROM Acrobat Reader**

**Windows :**

- ① CD-ROM CD-ROM
- ② " "
- ③ " CD-ROM "
- ④ " manuals "
- ⑤ " acrobat "
- ⑥ " windows "
- ⑦

**Macintosh :**

- ① CD-ROM CD-ROM
- ② " CD-ROM "
- ③ " manuals "
- ④ " acrobat "
- ⑤ " mac "
- ⑥

**OS :**  
 (http://www.adobe.com) Acrobat Reader

CD-ROM Acrobat Reader

**PDF**

**Windows :**

- ① CD-ROM CD-ROM
  - ② " "
  - ③ " CD-ROM "
  - ④ " manuals "
  - ⑤ " xg-nv7xm "
  - ⑥ ( ) pdf
  - ⑦ " nv7 "
- pdf " saps "

**Macintosh :**

- ① CD-ROM CD-ROM
  - ② " CD-ROM "
  - ③ " manuals "
  - ④ " xg-nv7xm "
  - ⑤ ( ) pdf
  - ⑥ " nv7 "
  - ⑦ pdf
- pdf " saps "

⑧ pdf

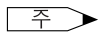

- pdf Acrobat Reader " File " , " Open "
- CD-ROM CD-ROM "readme.txt"



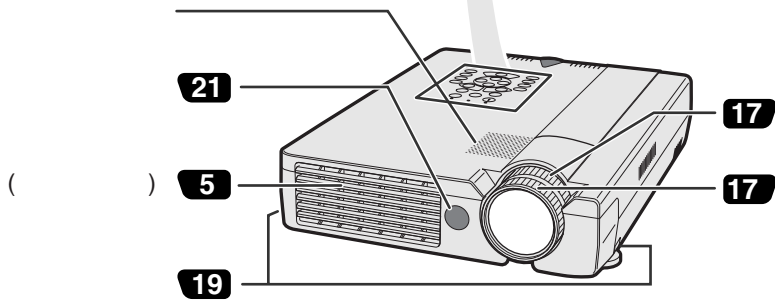
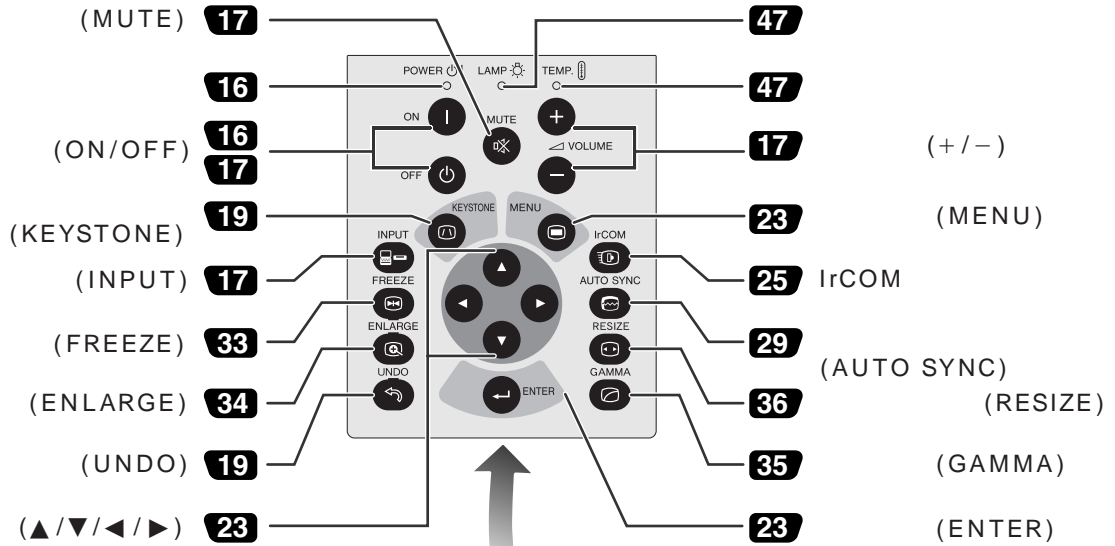

IrCOM

AC

2 (INPUT 2)

1 (INPUT 1) (HD 15)

(AUDIO INPUT) (3.5mm)

RS-232C (9-DIN)

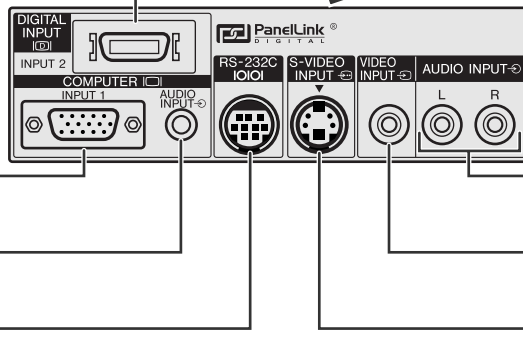
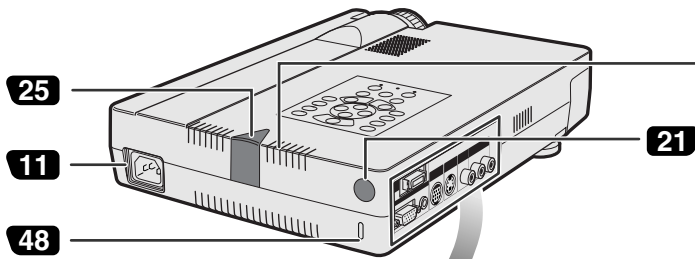

(AUDIO INPUT): RCA

(VIDEO INPUT): RCA

S-VIDEO INPUT: DIN



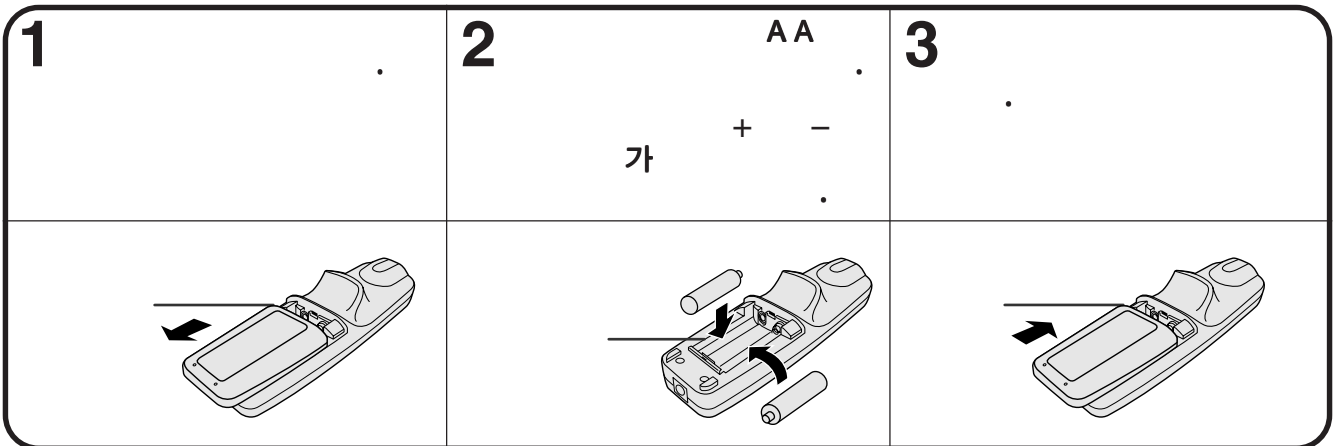
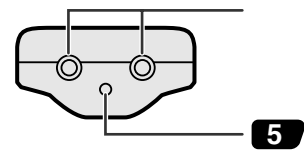
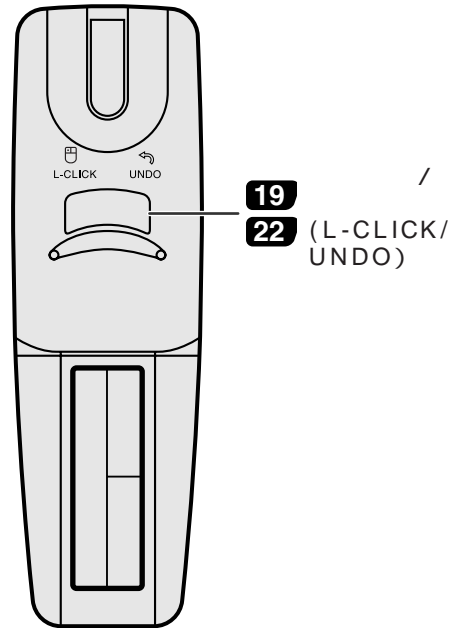
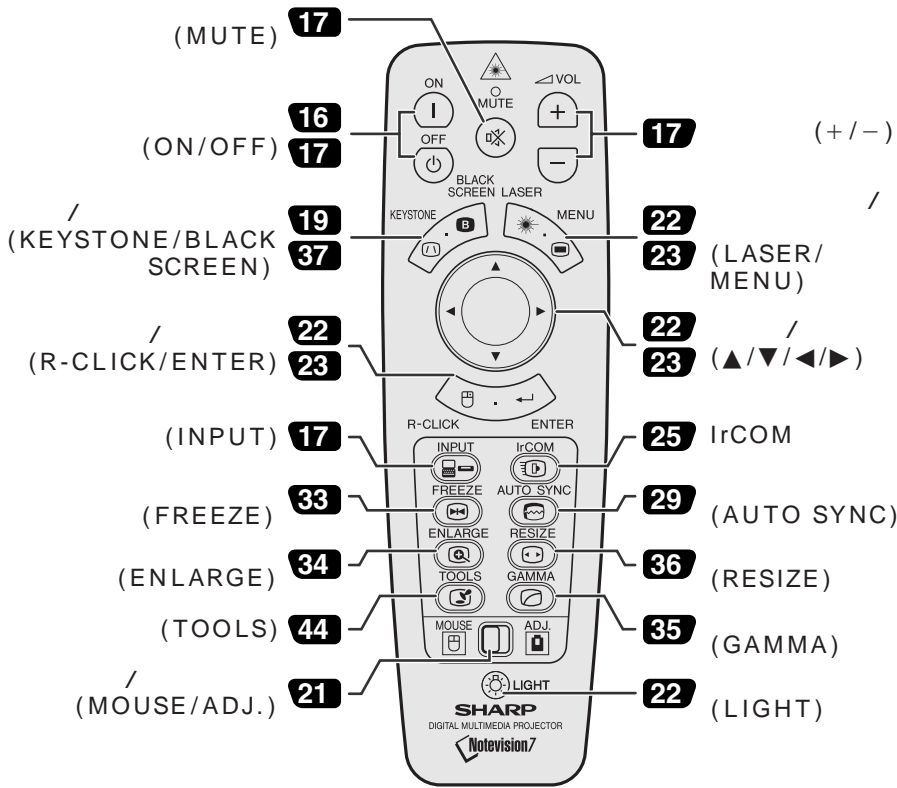

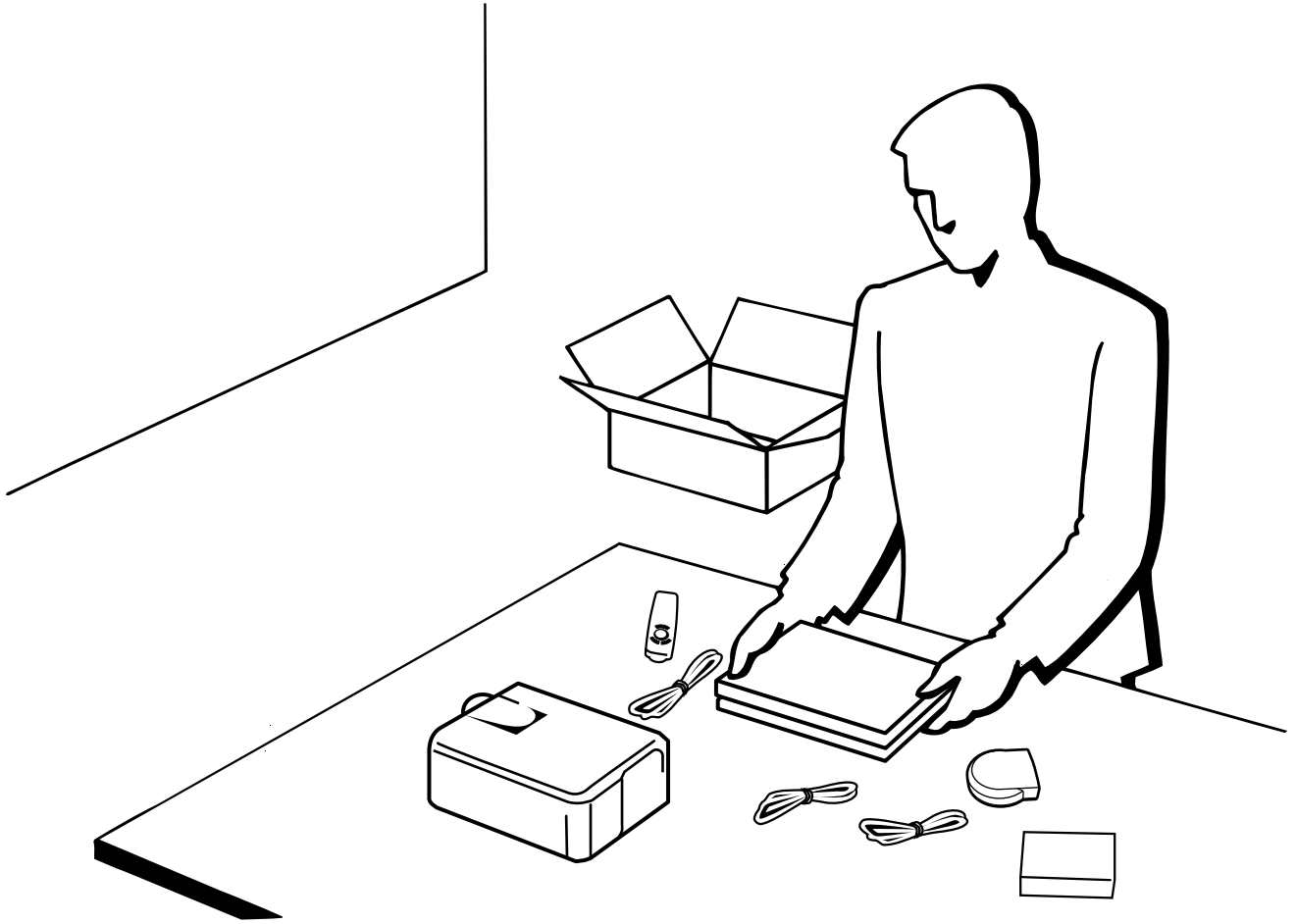



RRMCG1531CESA



AA 2

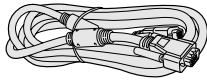
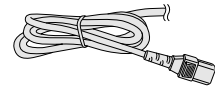

QCNW-5304CEZZ

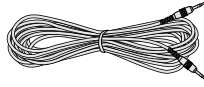

QCNW-4870CEZZ

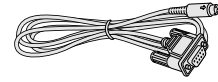

QCNW-5112CEZZ

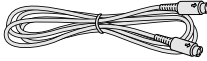

IBM PS/2

QCNW-5113CEZZ

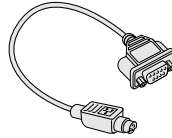

Mac

QCNW-5114CEZZ

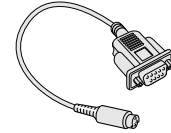

DIN-D-sub RS-232C  
QCNW-5288CEZZ

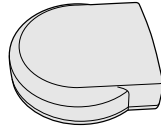
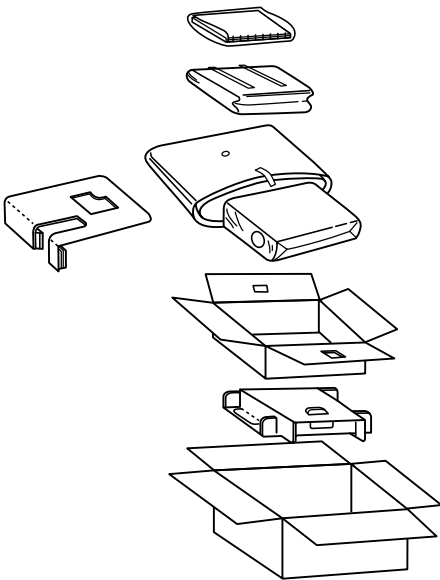

RUNTK0661CEZZ

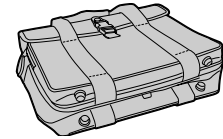

가  
GCASN0003CESA



GCOVH1308CESA



UBNDT0012CEZZ

CD-ROM  
UDSKA0017CE01

TINS-6912CEZZ

TINS-6911CEZZ

TINS-6914CEZZ

TINS-6913CEZZ

IrDA  
TCAUZ3051CEZZ





AC

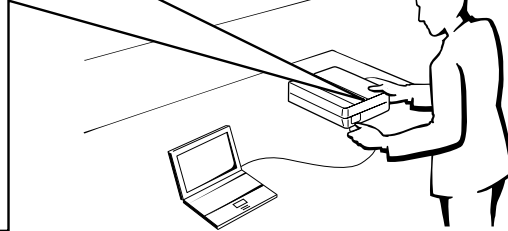
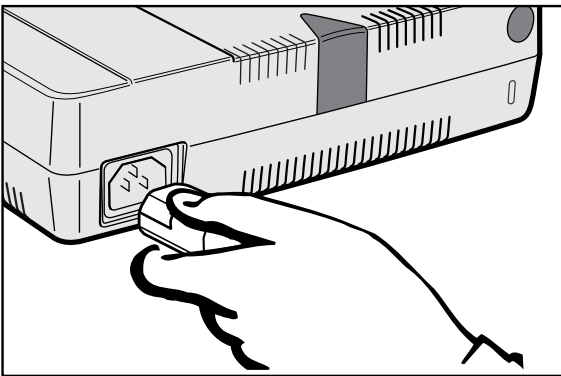

### 15 (VGA)

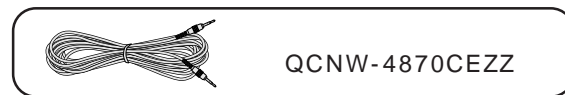
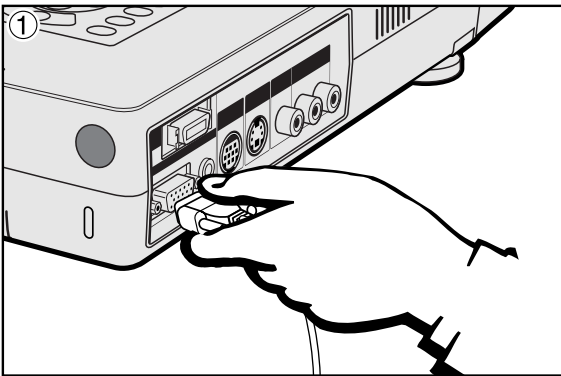

①

INPUT 1

②

③

AUDIO INPUT

④

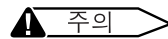

OFF

ON



54 55

“ ( ) ”



• Macintosh

Macintosh  
LCD

가



가  
 IBM-PC (VGA/SVGA/XGA/SXGA/UXGA) Macintosh( ) 가

GUI “ ” “ /RGB” . (40 )



- AUDIO INPUT INPUT 1 2
- “ & ”
- VESA 15 DDC 2B 가 VESA DDC 1/DDC 2B , 20 가 VESA DDC
- “ & ” 가 ON



- DDC, & 가 VESA DDC

**(PanelLink™)**

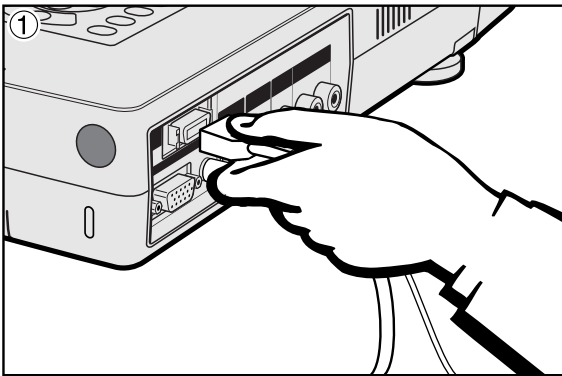

- ① INPUT 2
- ②
- ③ AUDIO INPUT

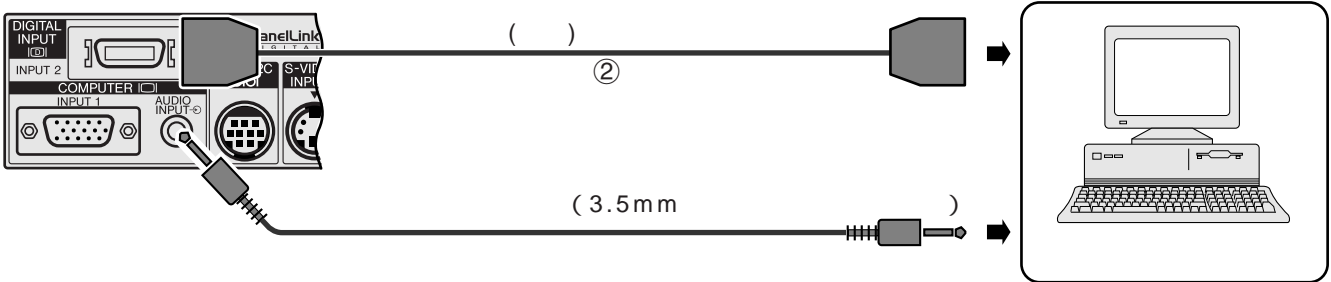



VCR , , DVD , DTV



OFF

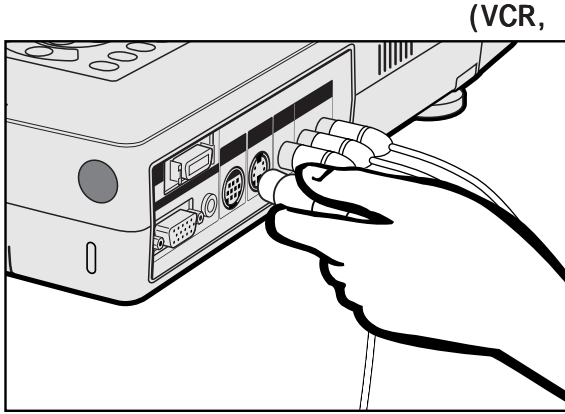

- ① RCA VIDEO INPUT
- ② RCA AUDIO INPUT
- S-VIDEO INPUT



- S-video
- S-video 가

S-VIDEO INPUT

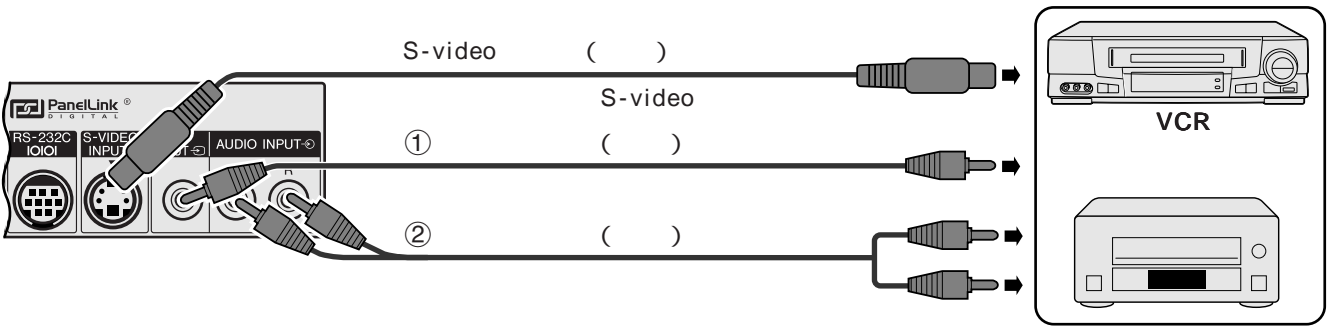

DTV DVD

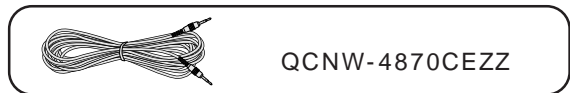
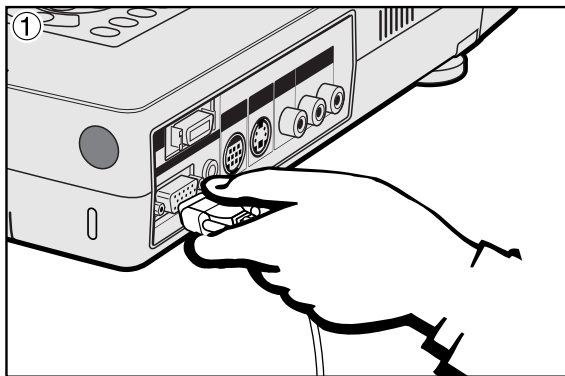

- ① HD-15-RGB INPUT 1
- ②
- ③ AUDIO INPUT

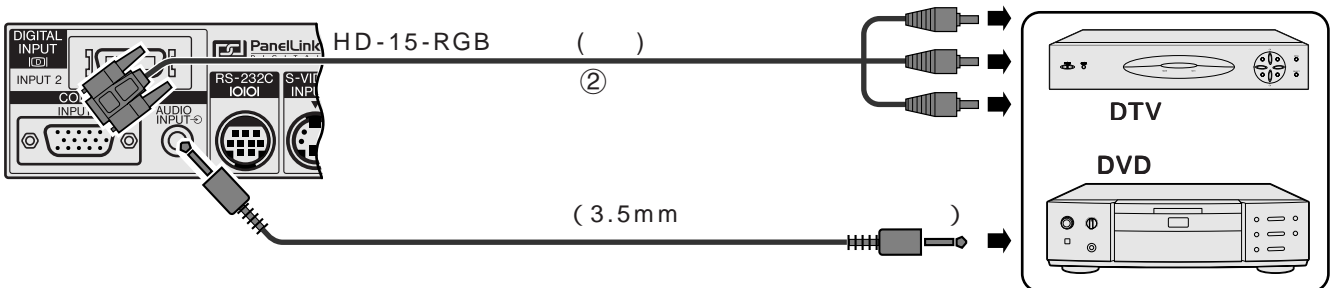
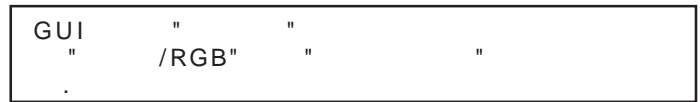



# RS-232C

RS-232C 가 RS-232C ( , )

52 53



QCNW-5304CEZZ

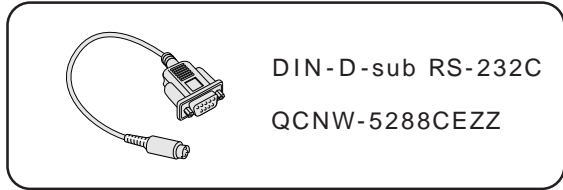

DIN-D-sub RS-232C

QCNW-5288CEZZ



QCNW-4870CEZZ

- ① DIN-D-sub RS-232C RS-232C
- ② RS-232C ( ) DIN-D-sub RS-232C

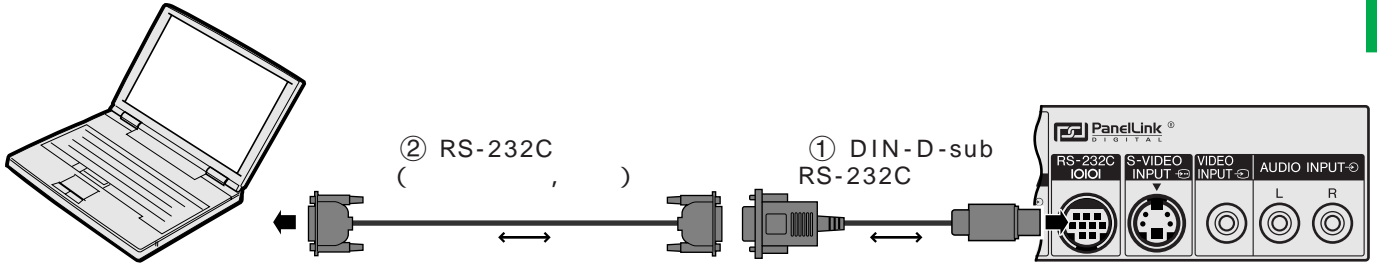

주의

ON

RS-232C



주

가

RS-232C

(→, ↔)





- RS-232C RS-232C ( , )
- 52 53

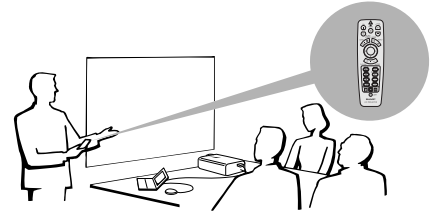

# IBM

# IBM PC

- ①
- ②

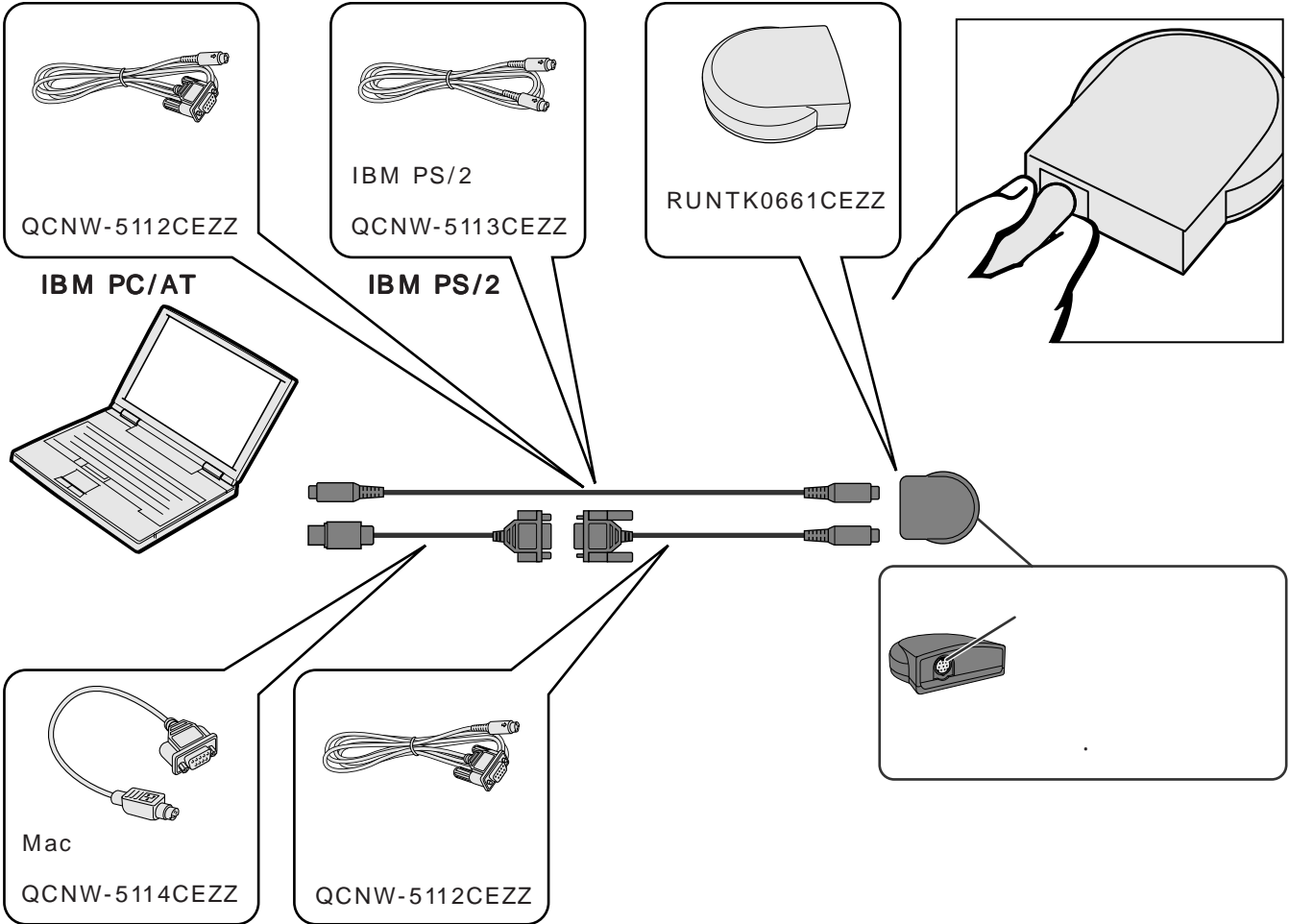

# Macintosh

- ①
- ② Macintosh Mac ADB Mac
- ③ Mac

**⚠ 주의**  
• ON

**주**  
• IBM PS/2, (RS-232C) ADB 가



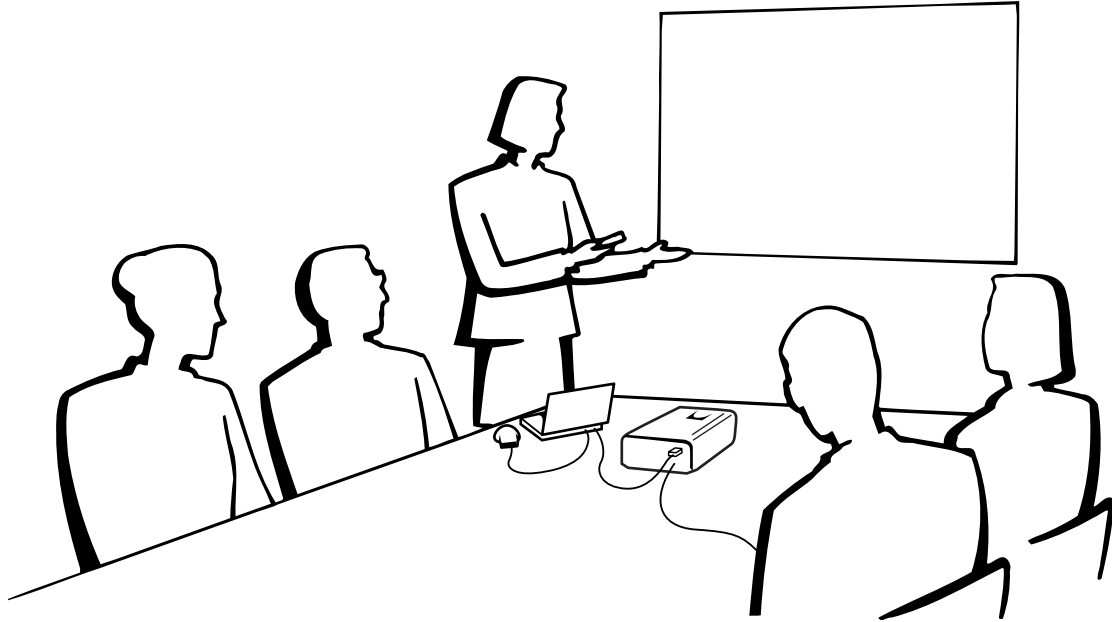

①

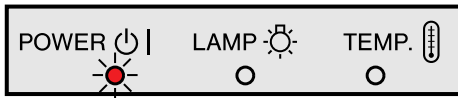

② ON

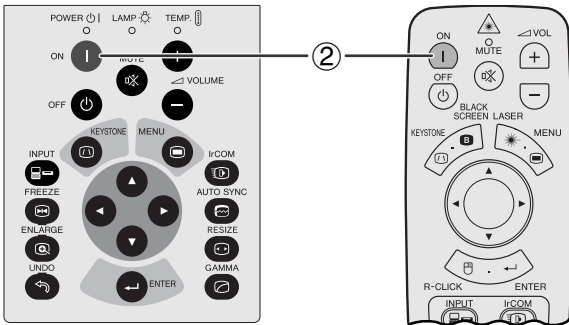

가

가

가

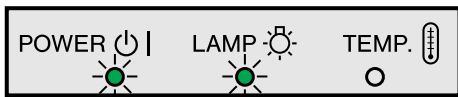

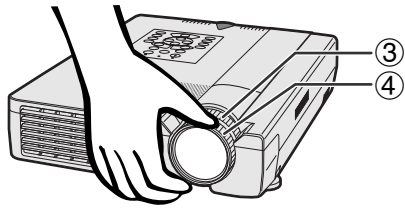

③

④

가

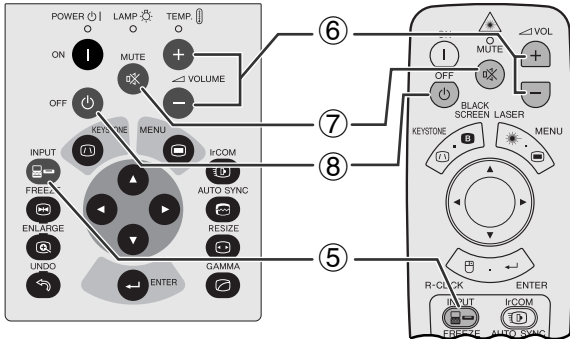

1

2

⑤

INPUT

INPUT



가

“

”

“

가”

가

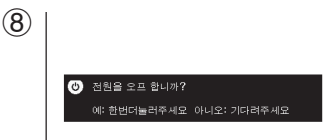
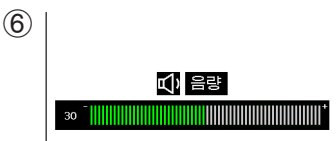

⑥

VOLUME +/-

⑦

MUTE

MUTE

⑧ OFF

가

OFF



• OFF

가  
OFF

OFF

90

가

• ON

ON



( )

( )

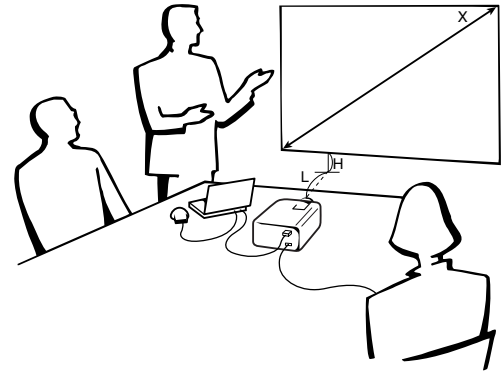

( 4:3 )

(diag.) (X)	(L)		(H)
762 cm (300")	—	12.2 m	89.0 cm
508 cm (200")	9.8 m	8.1 m	59.3 cm
381 cm (150")	7.3 m	6.1 m	44.5 cm
254 cm (100")	4.9 m	4.0 m	29.7 cm
213 cm (84")	4.1 m	3.4 m	24.8 cm
183 cm (72")	3.5 m	2.9 m	21.3 cm
152 cm (60")	2.9 m	2.4 m	17.8 cm
102 cm (40")	1.9 m	1.6 m	11.9 cm

( 16:9 )

(diag.) (X)	(L)		(H)
762 cm (300")	—	13.3 m	96.9 cm
508 cm (200")	10.6 m	8.8 m	64.6 cm
381 cm (150")	7.9 m	6.6 m	48.4 cm
338 cm (133")	7.0 m	5.9 m	43.0 cm
269 cm (106")	5.6 m	4.7 m	34.2 cm
254 cm (100")	5.3 m	4.4 m	32.3 cm
234 cm (92")	4.9 m	4.0 m	29.7 cm
213 cm (84")	4.4 m	3.7 m	27.1 cm
183 cm (72")	3.8 m	3.1 m	23.3 cm
152 cm (60")	3.1 m	2.6 m	19.4 cm
102 cm (40")	2.1 m	1.7 m	12.9 cm





2

1 가

1

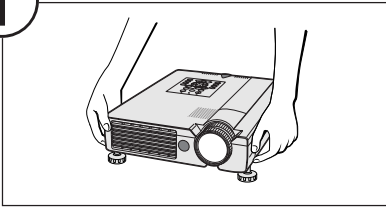

2

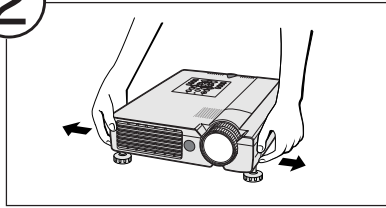

3

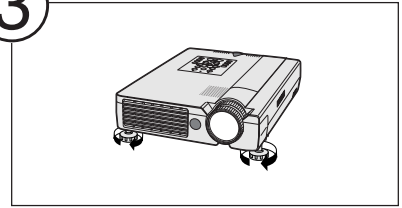

주

+5 , -3 가 ( )

! 주의

가

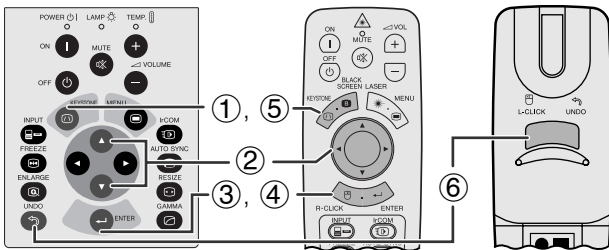

( ADJ. MOUSE/ADJ. )



1 KEYSTONE

2



3

ENTER

4

ENTER

5

KEYSTONE

6

UNDO

주

가

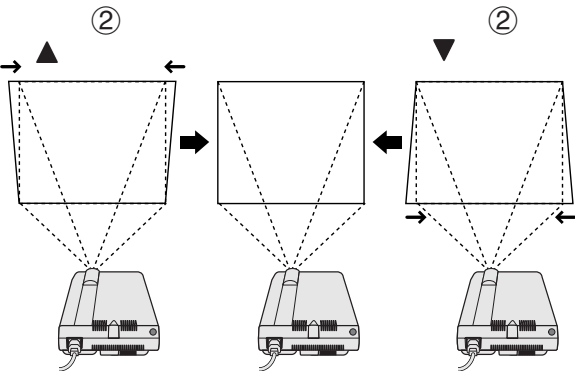

3

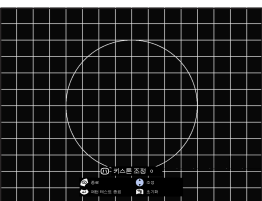

4

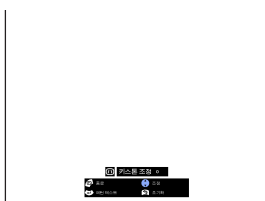



- ( )
- ( )
- ( )

- ( )
- ( )
- ( )

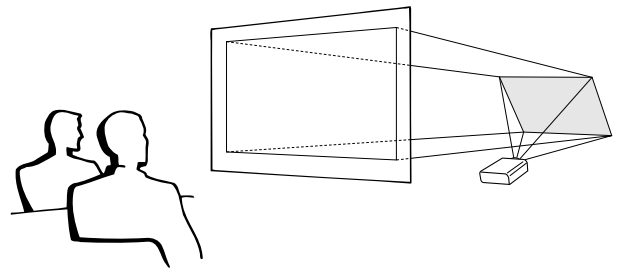
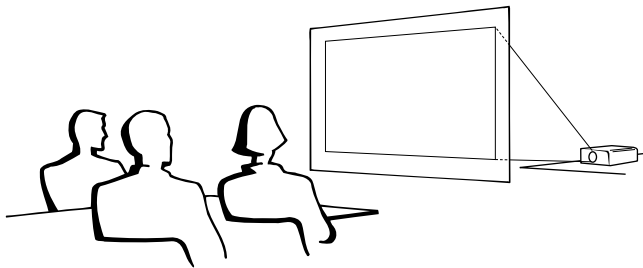

주

- 가

주의

- ( )
- 가 LCD (AN-NV7T, AN-TK201/202)
- NV7T (AN-NV7T)
- 가 (AN-NV7T)
- ( )
- 43 ( )

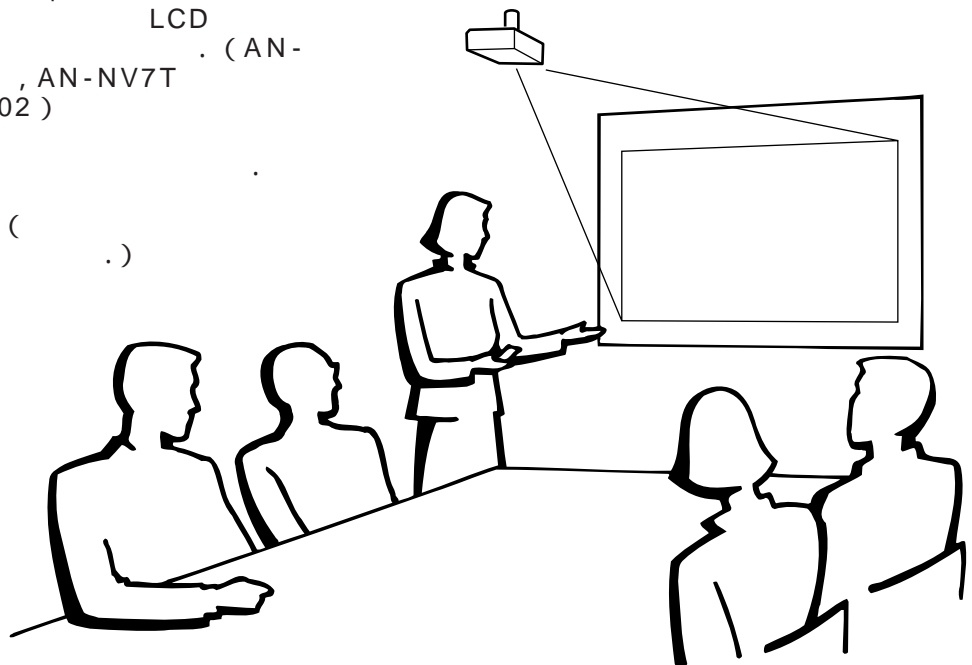

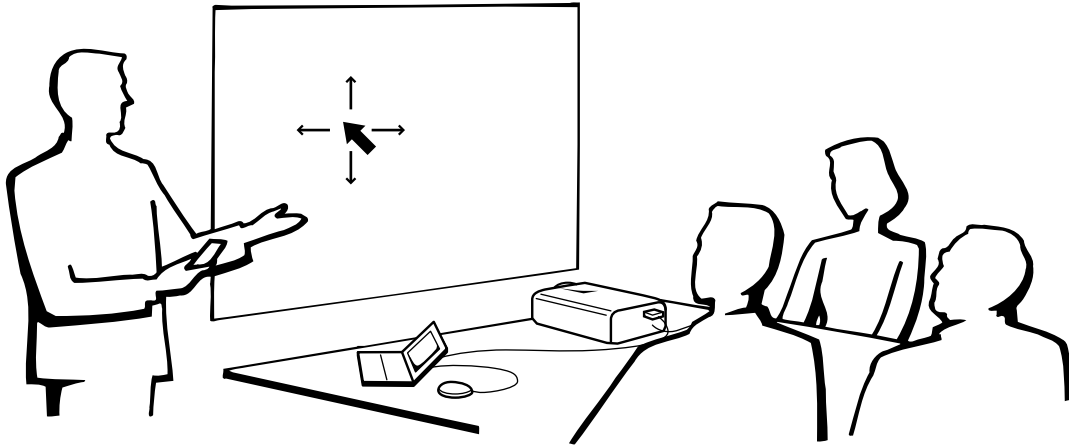

가

MOUSE/ADJ.

( )

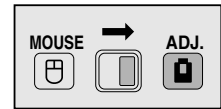
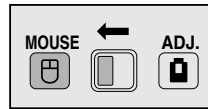

- 
- 
- 



/

- 
- 

주

- 

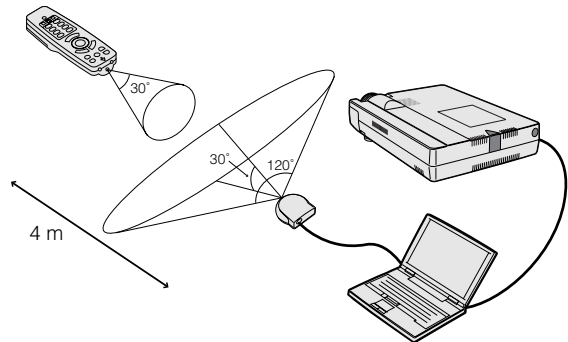
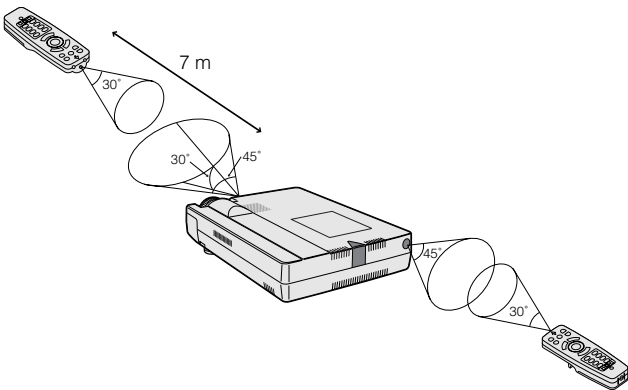



가

1



**MOUSE/ADJ.**

**MOUSE**

**MOUSE**

BLACK SCREEN **B**

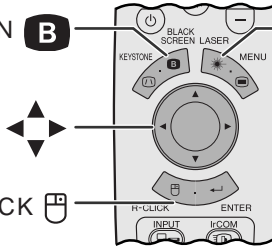

LASER

L-CLICK

R-CLICK



- 
- 

가

**L-CLICK    R-CLICK**



**LIGHT**

	MOUSE/ADJ.	
	MOUSE ( ) ←→	ADJ. ( )
LASER/MENU	LASER ( )	MENU ( )
BLACK SCREEN/KEYSTONE	BLACK SCREEN ( )	KEYSTONE ( )
R-CLICK/ENTER	R-CLICK ( )	ENTER ( )
/	( )	( )
L-CLICK/UNDO	L-CLICK ( )	UNDO ( )
ON/OFF	ON ( )	
VOL +/-		
MUTE		

	MOUSE/ADJ.	
	MOUSE ( ) ←→	ADJ. ( )
INPUT		
IrCOM		
FREEZE		
AUTO SYNC		ON ( )
ENLARGE		
RESIZE		
TOOLS		
GAMMA		

1



**MOUSE/ADJ.**

**MOUSE**

2



LASER



- 1

**LASER ( \* )**  
OFF

**LASER ( \* )**

OFF가 . ON





# GUI (Graphical User Interface)

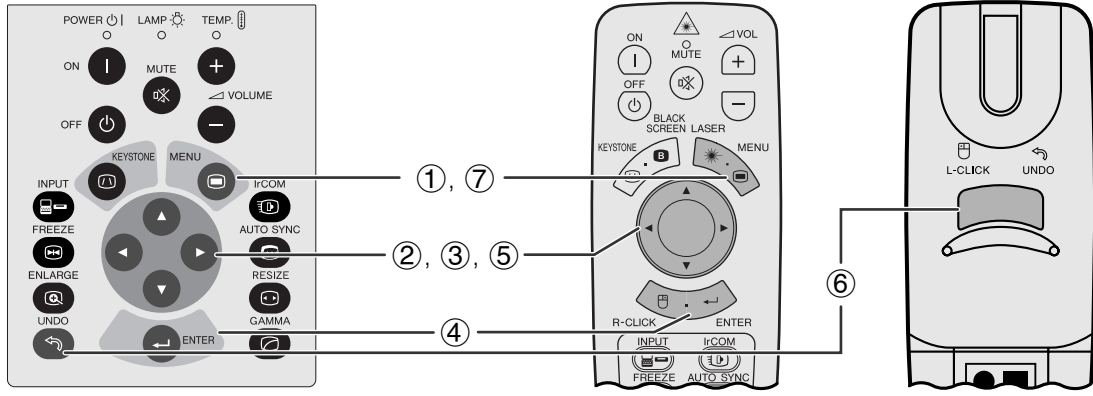

2 ( / )

## (GUI)

( / RGB )

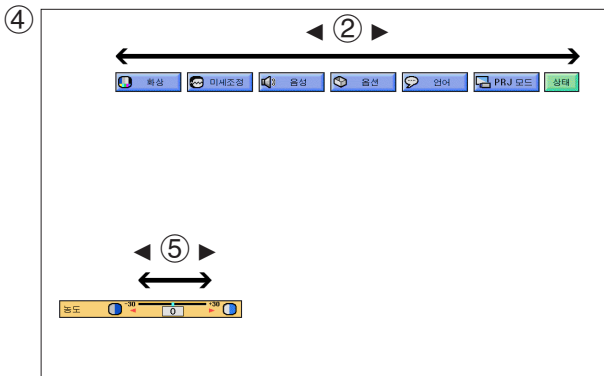
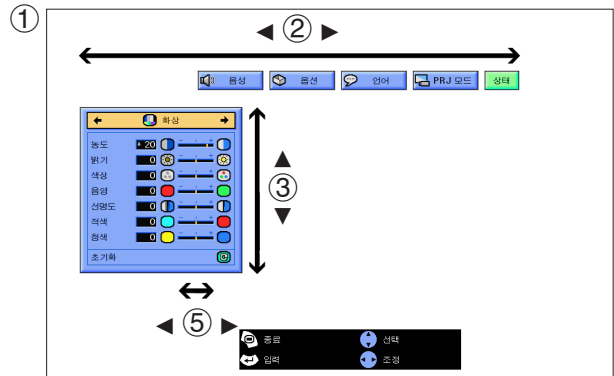
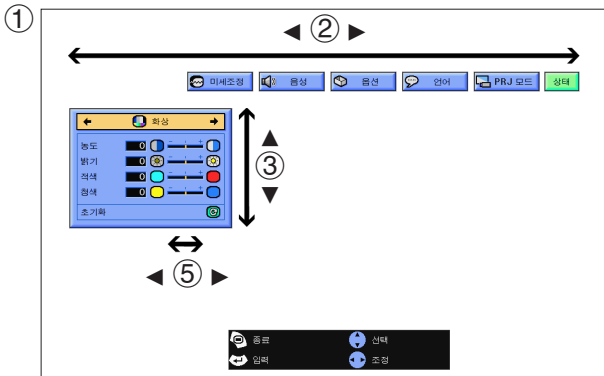

( ADJ. MOUSE/ADJ. )

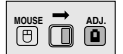

① MENU

② </>

③ ▲ / ▼

④ ENTER

⑤ </>

⑥ 가 UNDO

⑦ MENU GUI







# GUI (Graphical User Interface)

1 2

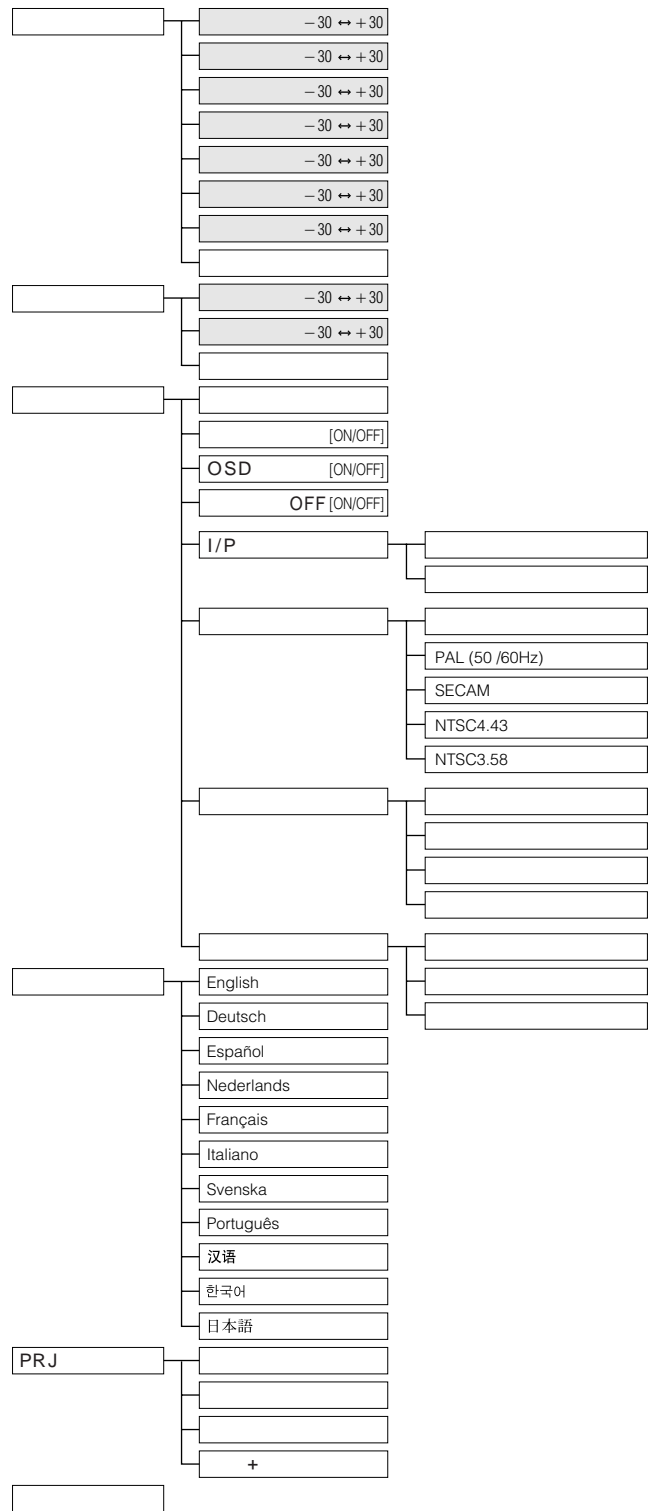
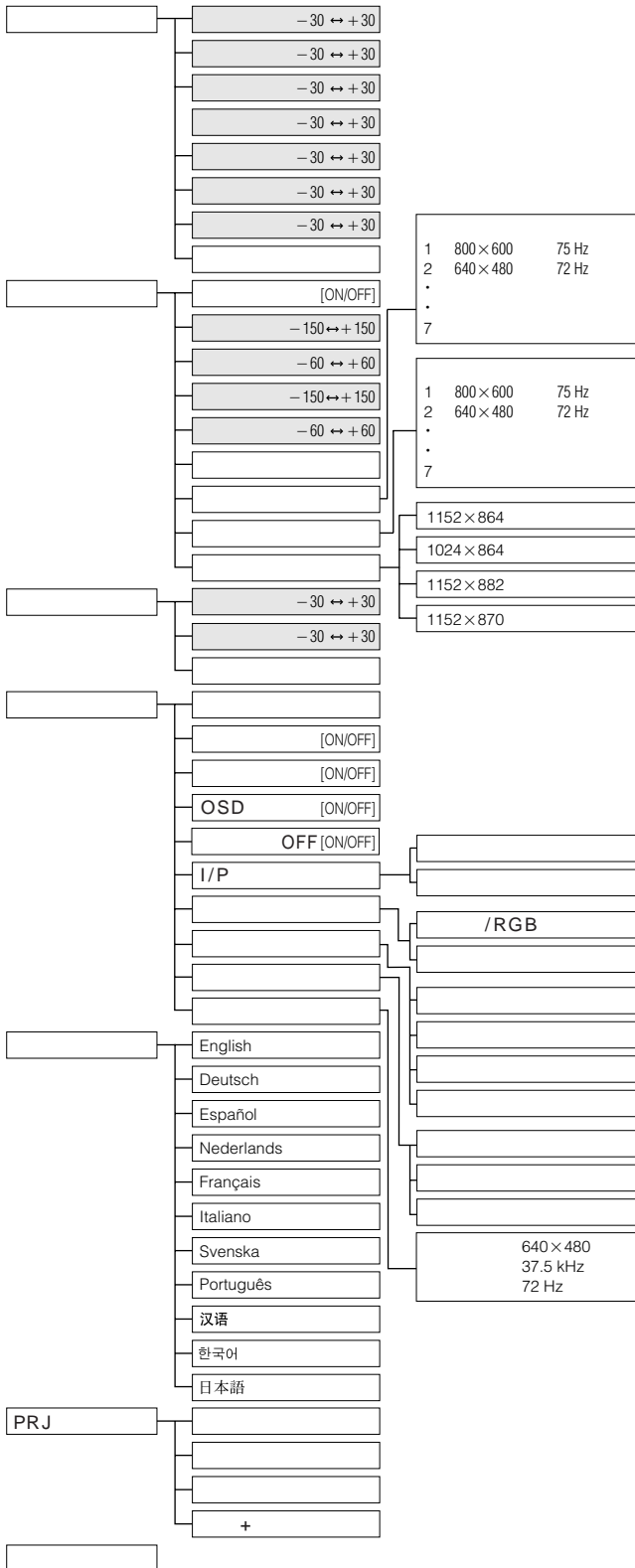

天

“ ” “ ” , “ ”

/RGB





# IrCOM

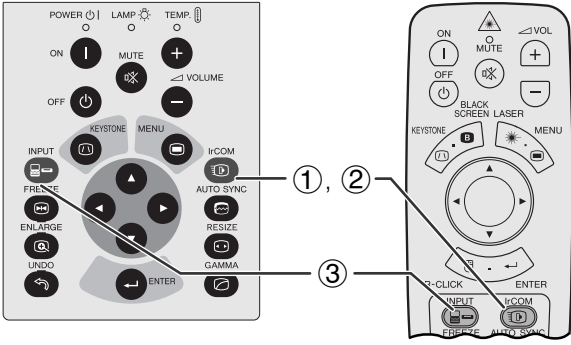

IrCOM  
( )

- 가 CD-ROM SAPS (SAPS)
- IrCOM



- IrCOM
- 가
- IrCOM
- 10cm
- 10cm 1m

( MOUSE/ADJ. ADJ. )

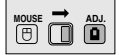

① IrCOM 가 IrCOM

②



- IrCOM 가 IrCOM

③ IrCOM INPUT

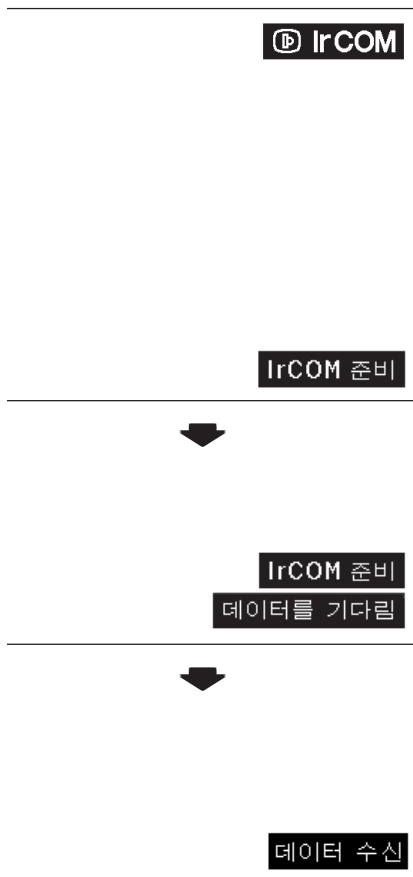
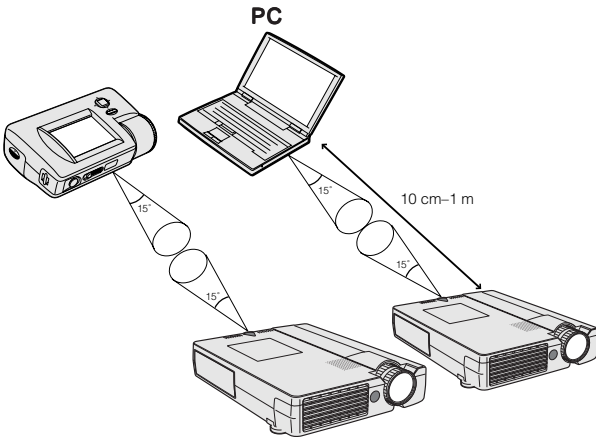

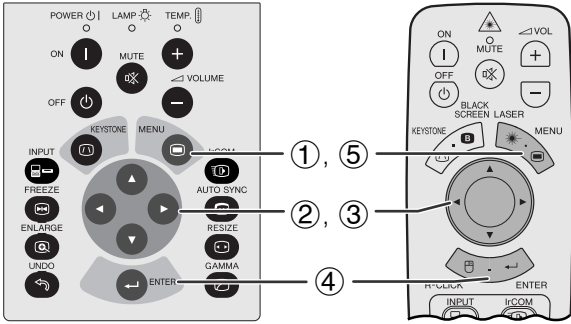

( GUI )



( MOUSE/ADJ. )



① MENU

② ◀/▶

③ ▲/▼

④ ENTER

⑤ MENU

GUI



( )

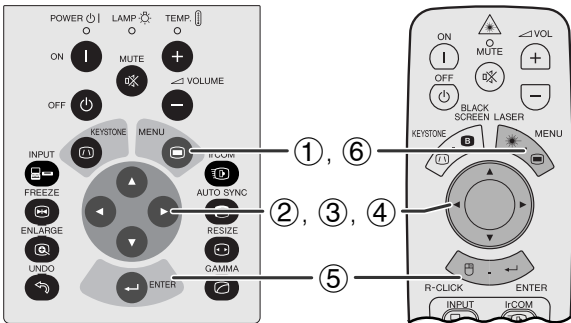

( GUI )

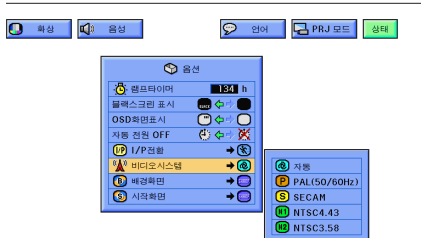

( MOUSE/ADJ. )



① MENU

② ◀/▶

③ ▲/▼

④ ▲/▼

⑤ ENTER

⑥ MENU

GUI



가 가

“ ”

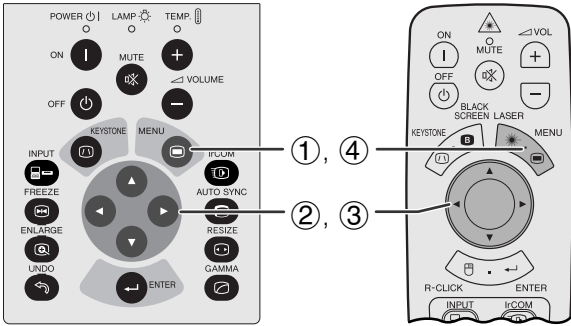

	◀	▶

( GUI )  
( / RGB )

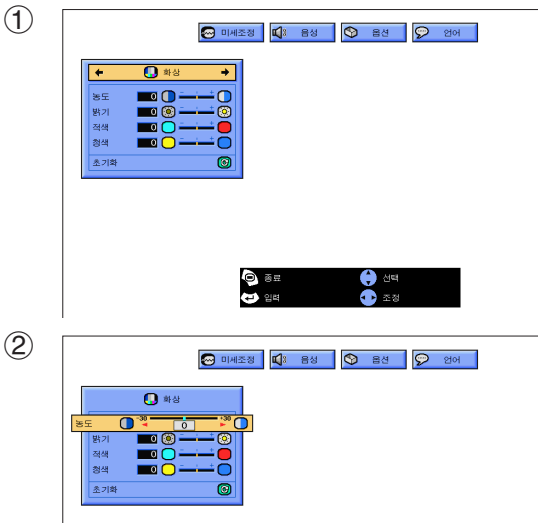

주  
• “ ” “ ” “ ” “ ”  
/ RGB

( MOUSE/ADJ. ADJ. )



① MENU “ ” . GUI

② ▲/▼

③ ◀/▶

④ MENU GUI

주  
• “ ” ENTER

• “ 1 ”, “ 2 ” “ ”

• 1 가 “ ” DVD

• “ ” GUI

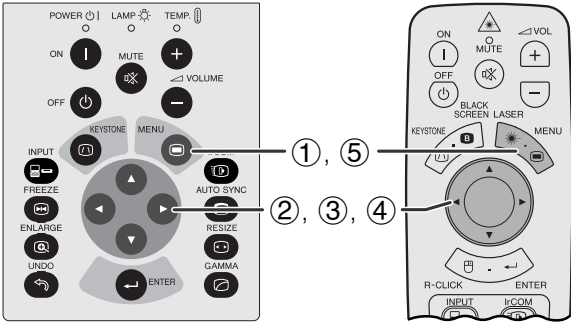

	◀	▶

( GUI )

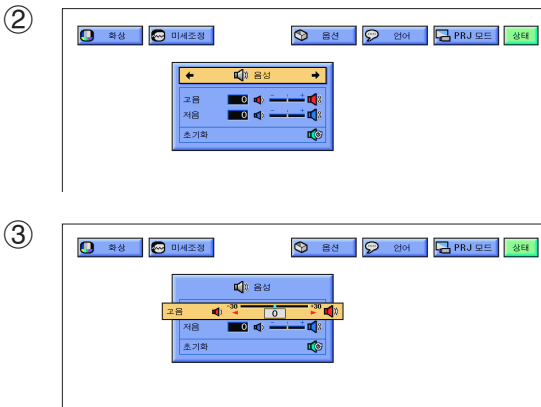

( ADJ. MOUSE/ADJ. )



① MENU

② ◀/▶

③ ▲/▼

④ ◀/▶

⑤ MENU

“ ”  
 . GUI  
 “ ”  
 .  
 “ ”  
 . GUI



“ ”  
 . ENTER  
 “ ”





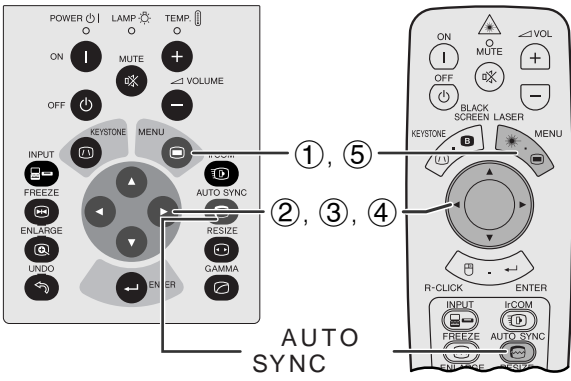

(GUI)

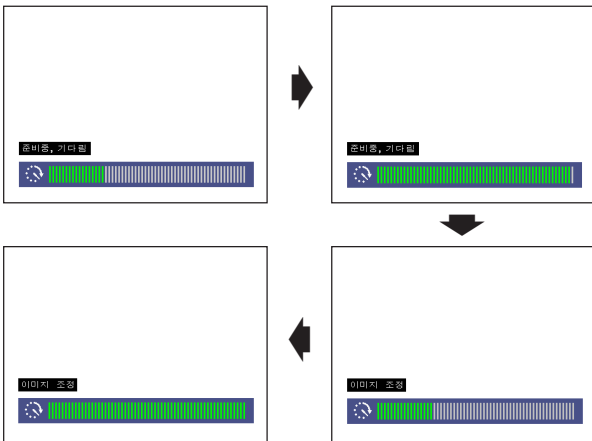
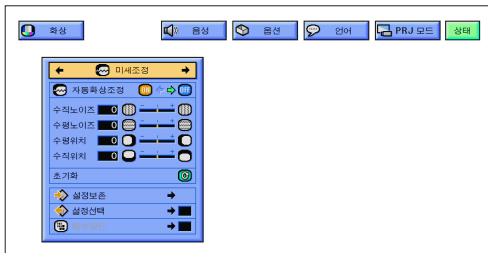

(GUI)



•  
•  
• **AUTO SYNC** GUI  
• “ ” “ ON ”  
• “ ” “ ON ” 가  
•

(  
ADJ. **MOUSE/ADJ.**  
.)

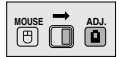

- ① MENU
- ② ◀/▶
- ③ ▲/▼
- ④ ◀/▶ “ ON ”
- ⑤ MENU GUI



• **AUTO SYNC** 가  
• 가 가  
• ( 가  
• 가



(  
ADJ. **MOUSE/ADJ.**  
.)

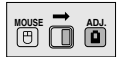

- ① MENU
- ② ◀/▶
- ③ ▲/▼
- ④ ◀/▶ “ □ ” “ ⦿ ”
- ⑤ MENU GUI



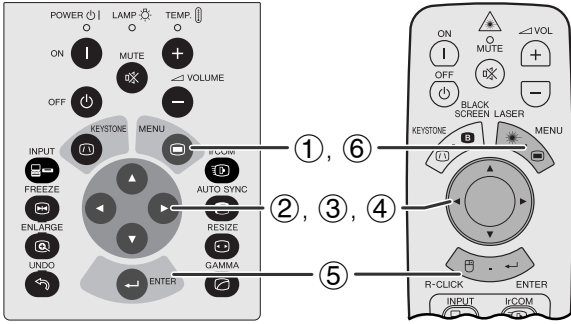

(GUI)

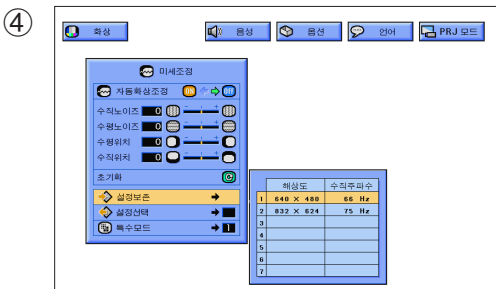

7가

( ADJ. MOUSE/ADJ. )

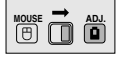

① MENU

② ◀/▶ “ ”

③ ▲/▼ “ ” ▶

④ ▲/▼

⑤ ENTER

⑥ MENU GUI

( ADJ. MOUSE/ADJ. )



① MENU

② ◀/▶ “ ”

③ ▲/▼ “ ” ▶

④ ▲/▼

⑤ ENTER

⑥ MENU GUI



가

가



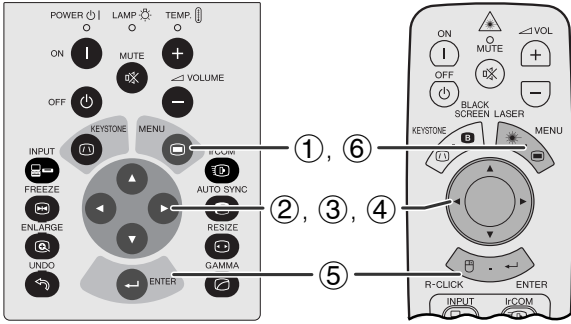

( GUI )

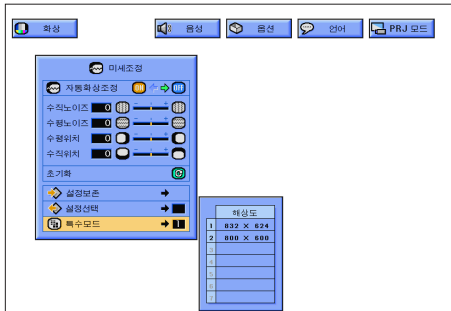

가 “ ” “ ” 가

( ADJ. MOUSE/ADJ. )



① MENU

② ◀/▶

③ ▲/▼

④ ▲/▼

⑤ ENTER

⑥ MENU

GUI



• ( ) ( )

• DTV 480P “ 480P ”

④



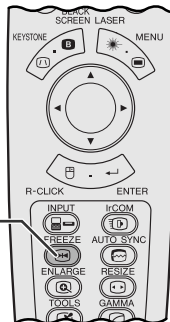
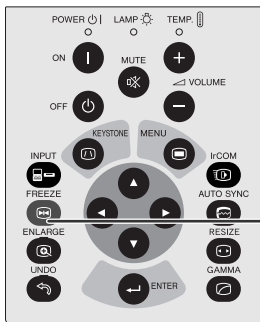
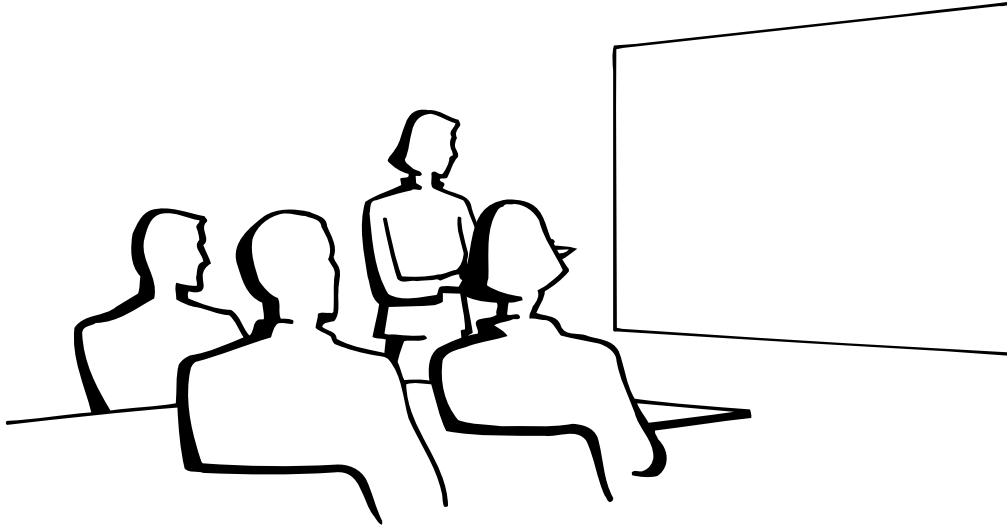
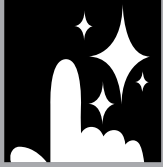

①, ②

① FREEZE

② FREEZE



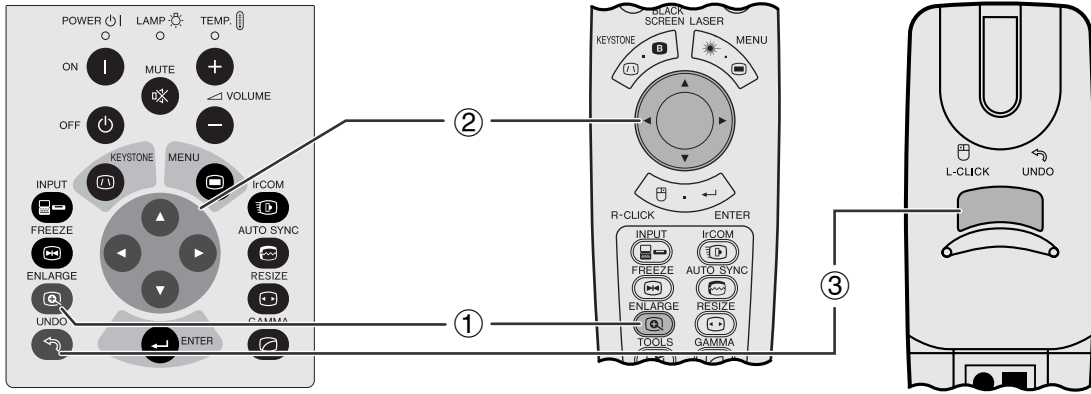

가

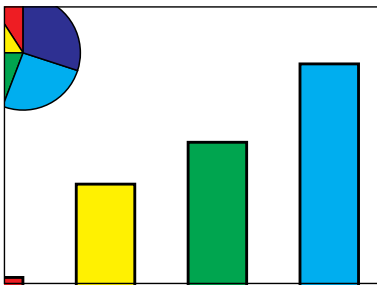
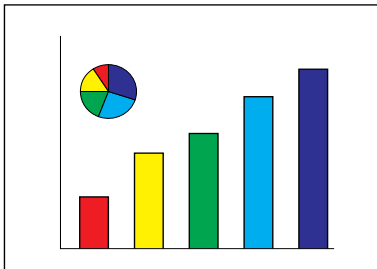

( MOUSE/ADJ. ADJ. )

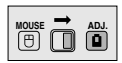

① ENLARGE

ENLARGE

②



• ENLARGE

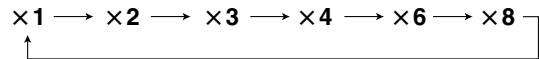

•

x 1

가

(a) INPUT

(b) 가

(c)

③ x 1 가 UNDO



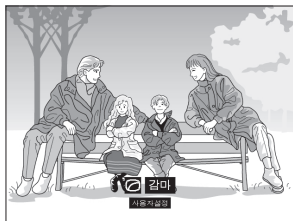
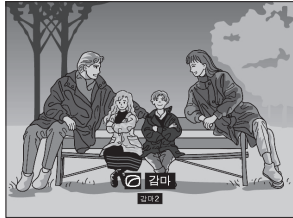
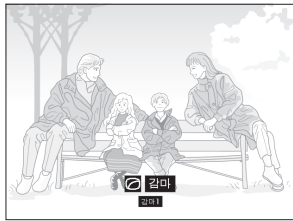
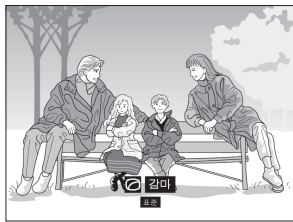
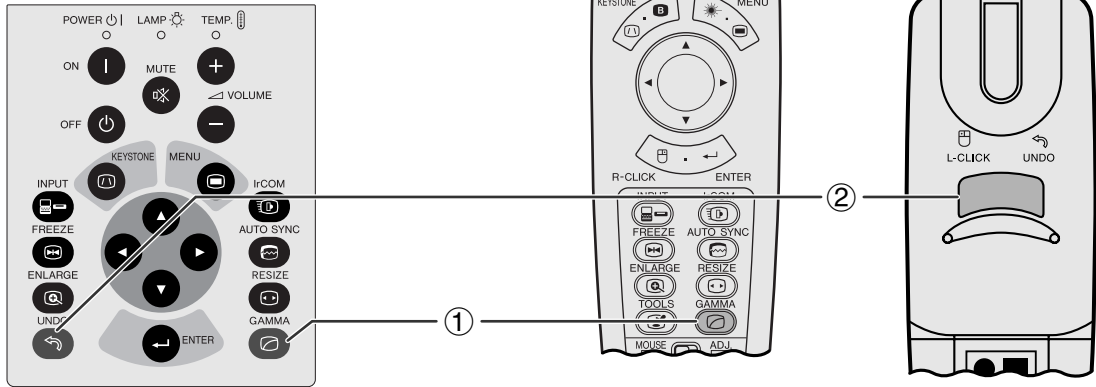

1

2

• 4가

• 가

1	
2	

( MOUSE/ADJ. ADJ. )



① GAMMA . GAMMA

② 가 “ ” 가  
UNDO



( )

주

• **RESIZE**

- “ ” 4:3 가 SXGA 가 LCD
- UNDO

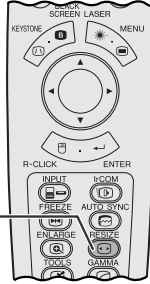
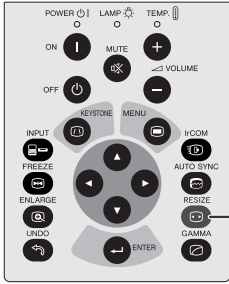

여

	DTV		SXGA	PAL
	4:3	16:9		
	480 P	720 P		
	1024 × 768	1024 × 576	960 × 768	1024 × 768
	1024 × 576	—	1024 × 768	1024 × 576
	640 × 480	1280 × 720	1280 × 1024	720 × 540
( )	853 × 480	—	—	—

RESIZE

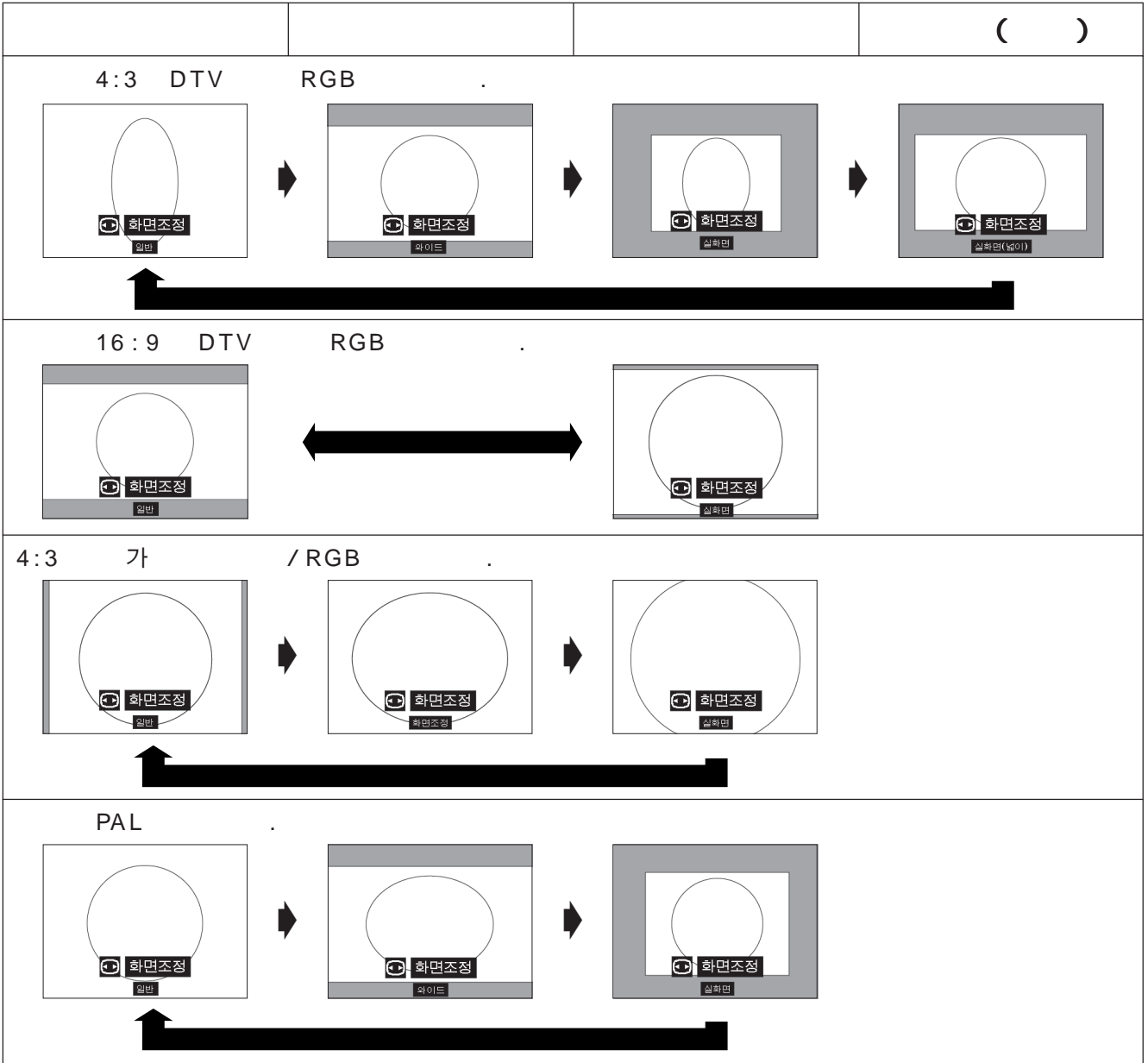

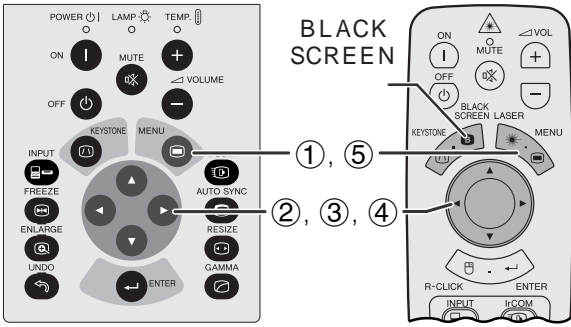

BLACK SCREEN

BLACK SCREEN  
BLACK SCREEN

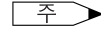

BLACK SCREEN  
MOUSE/ADJ. MOUSE

가

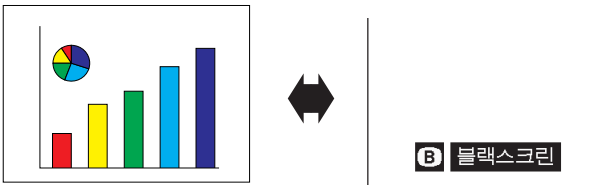

( GUI )



GUI

MOUSE/ADJ.  
ADJ.

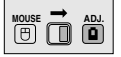

① MENU

② ◀/▶

③ ▲/▼

④

⑤ MENU

GUI

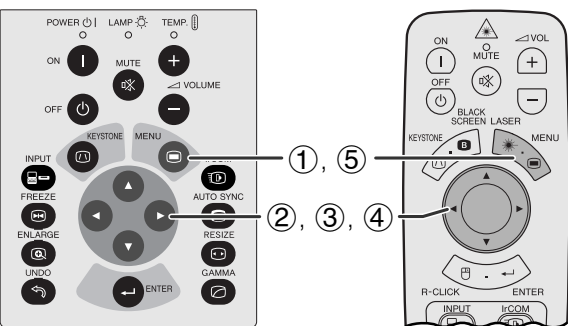

( GUI )



INPUT OSD IrCOM GUI

MOUSE/ADJ.  
ADJ.

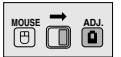

① MENU

② ◀/▶

③ ▲/▼

④

⑤ MENU

GUI



가 15

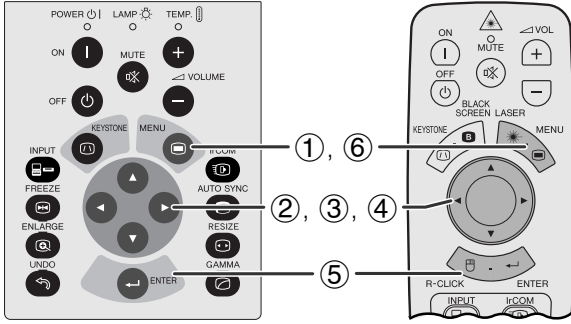

( ADJ. MOUSE/ADJ. )



- ① MENU
- ② ◀/▶ “ ”
- ③ ▲/▼ “ OFF ”
- ④ ◀/▶ " " "X"
- ⑤ ENTER
- ⑥ MENU GUI

( GUI )

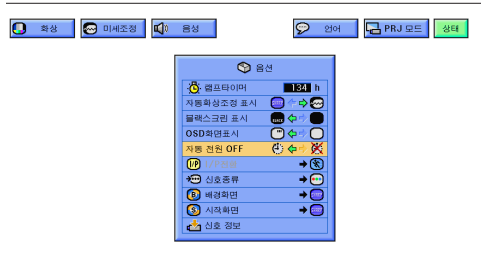

5

가

5분후 전원 꺼짐



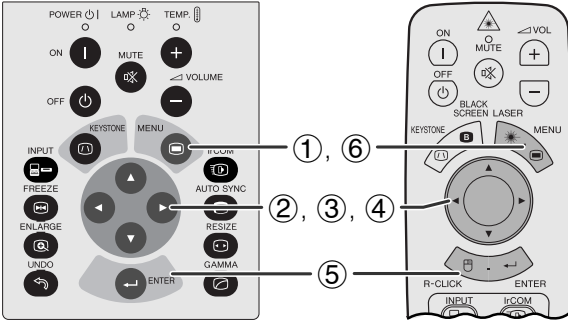

( GUI )



( ADJ. MOUSE/ADJ. )



① MENU

② ◀/▶ “ ”

③ ▲/▼ “ I/P ” ▶

④ ▲/▼ “ ” “ ” “ ”

⑤ ENTER

⑥ MENU GUI

가

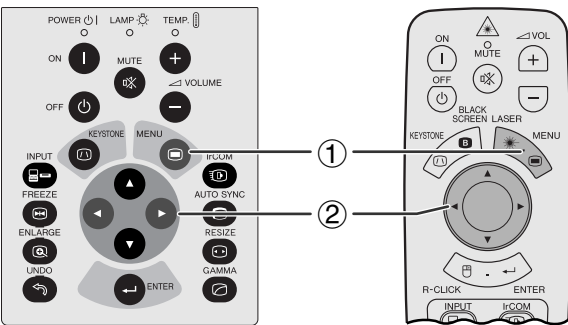

( GUI )



( ADJ. MOUSE/ADJ. )

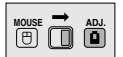

① MENU

② ◀/▶ “ ”



1,400

가 LCD

47



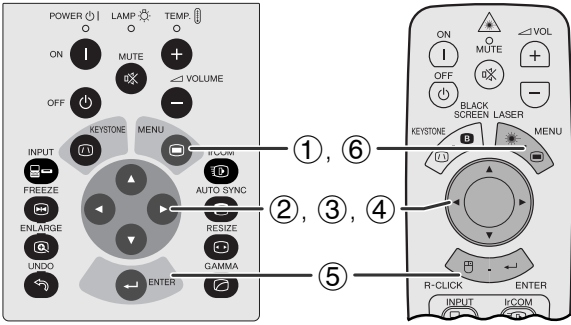

( GUI )

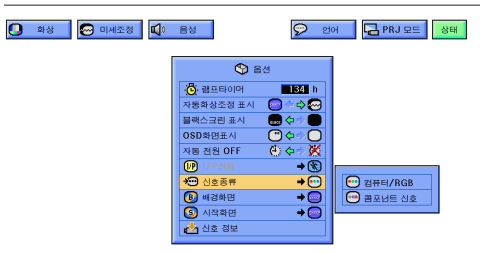

INPUT 1  
( /RGB )

( ADJ. MOUSE/ADJ. )

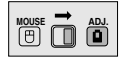

- ① MENU
- ② ◀/▶ “ ”
- ③ ▲/▼ “ ” ▶
- ④ ▲/▼ “ /RGB ” “ ”
- ⑤ ENTER
- ⑥ MENU GUI

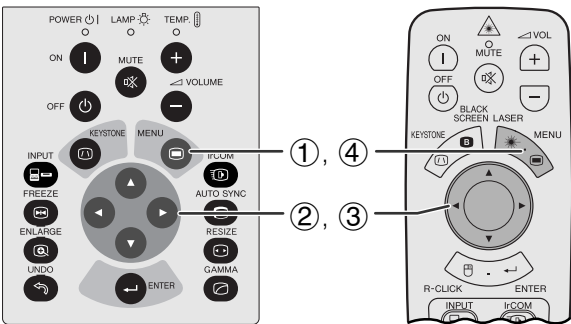

( GUI )

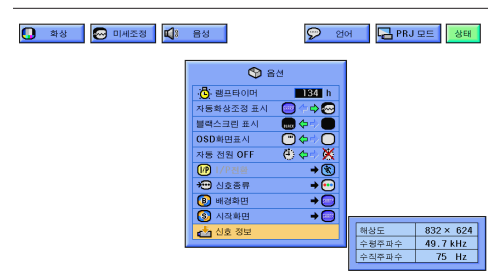

( ADJ. MOUSE/ADJ. )

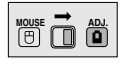

- ① MENU
- ② ◀/▶ “ ”
- ③ ▲/▼ “ ”
- ④ MENU GUI

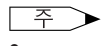



가

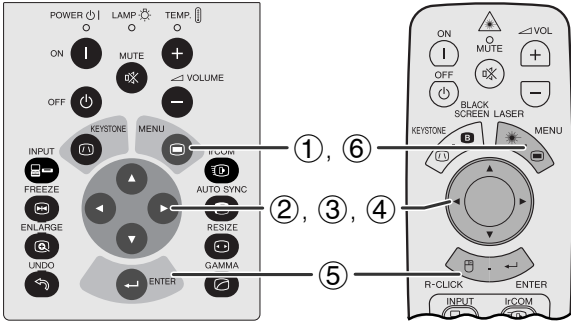

(GUI)



	가 ( : )

( ADJ. MOUSE/ADJ. . )

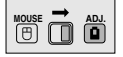

① MENU

② ◀/▶

③ ▲/▼

④ ▲/▼

⑤ ENTER

⑥ MENU

GUI



• “ ”

가  
( : )  
1,024 × 768  
256 BMP  
( )

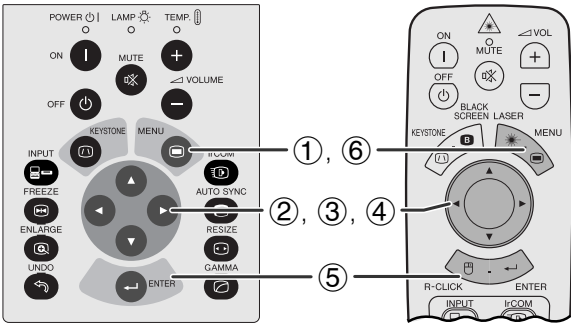

( GUI )



- IrCOM ( RS-232C ) 14 25

	가 ( : )

( ADJ. MOUSE/ADJ. )

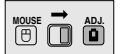

- ① MENU
- ② ◀/▶ “ ”
- ③ ▲/▼ “ ” ▶
- ④ ▲/▼

⑤ ENTER

⑥ MENU

GUI

- 주 “ ” 가 ( : ) 1,024 × 768 256 BMP ( )



/

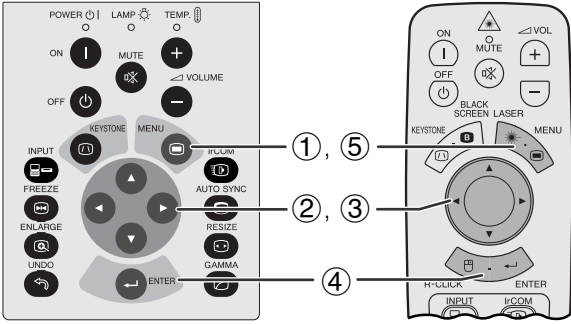

	+
+	+

( GUI )

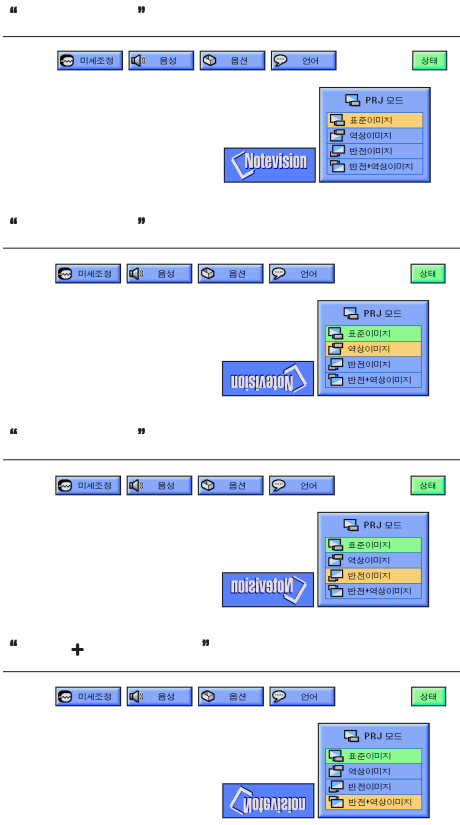

( ADJ. MOUSE/ADJ. )

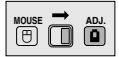

- ① MENU “ PRJ ”
- ② ◀/▶
- ③ ▲/▼
- ④ ENTER
- ⑤ MENU GUI



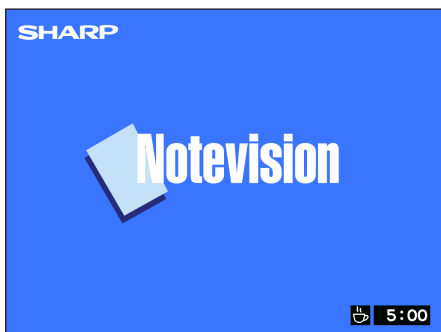
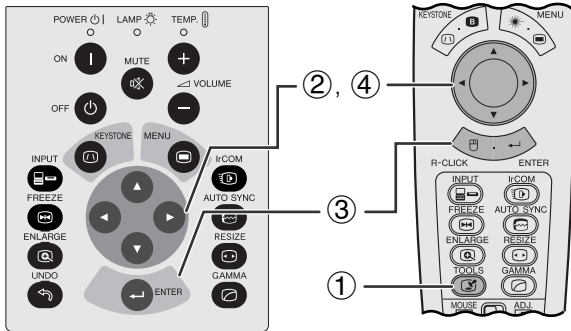
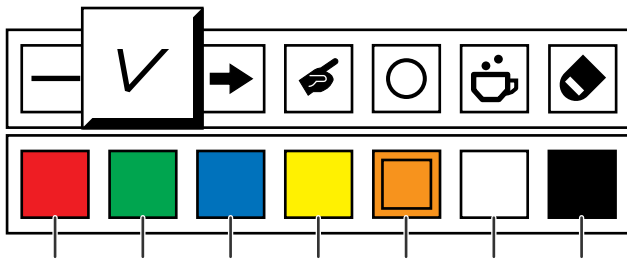
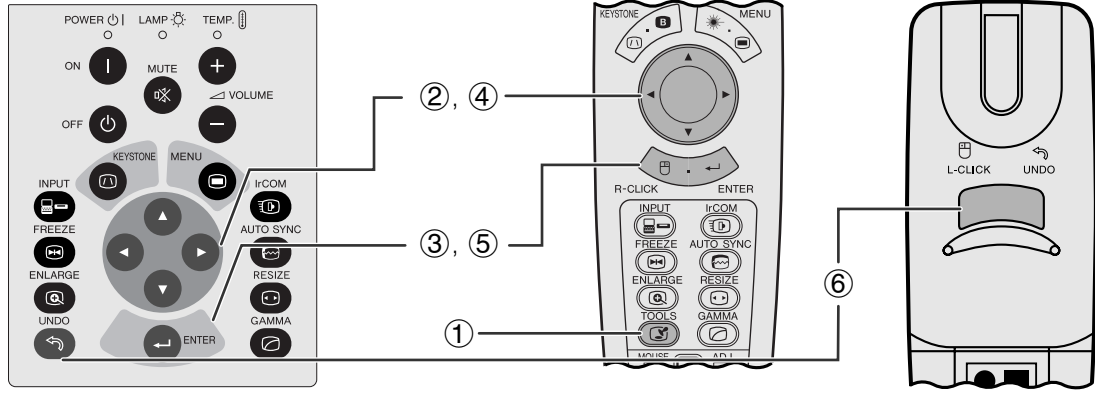

( ADJ. MOUSE/ADJ. )

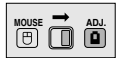

① TOOLS

② ▲/▼/◀/▶

③ ENTER

④ ▲/▼/◀/▶

⑤ ENTER

⑥ UNDO



“ [ ] ”

ENTER



( ADJ. MOUSE/ADJ. )

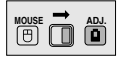

① TOOLS

② ▲/▼/◀/▶



③ ENTER

④ ▼ ▲



( 42 )

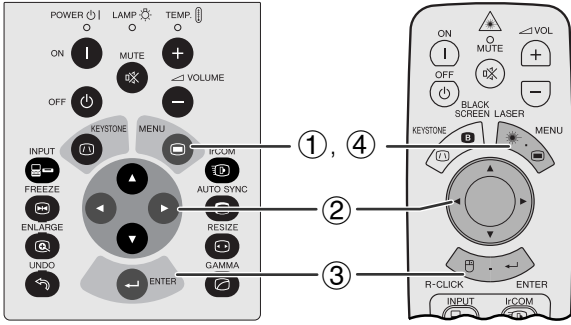

( MOUSE/ADJ.  
ADJ. . )



① MENU

② ◀▶

③ ENTER

④ MENU

GUI

( GUI )

②



③



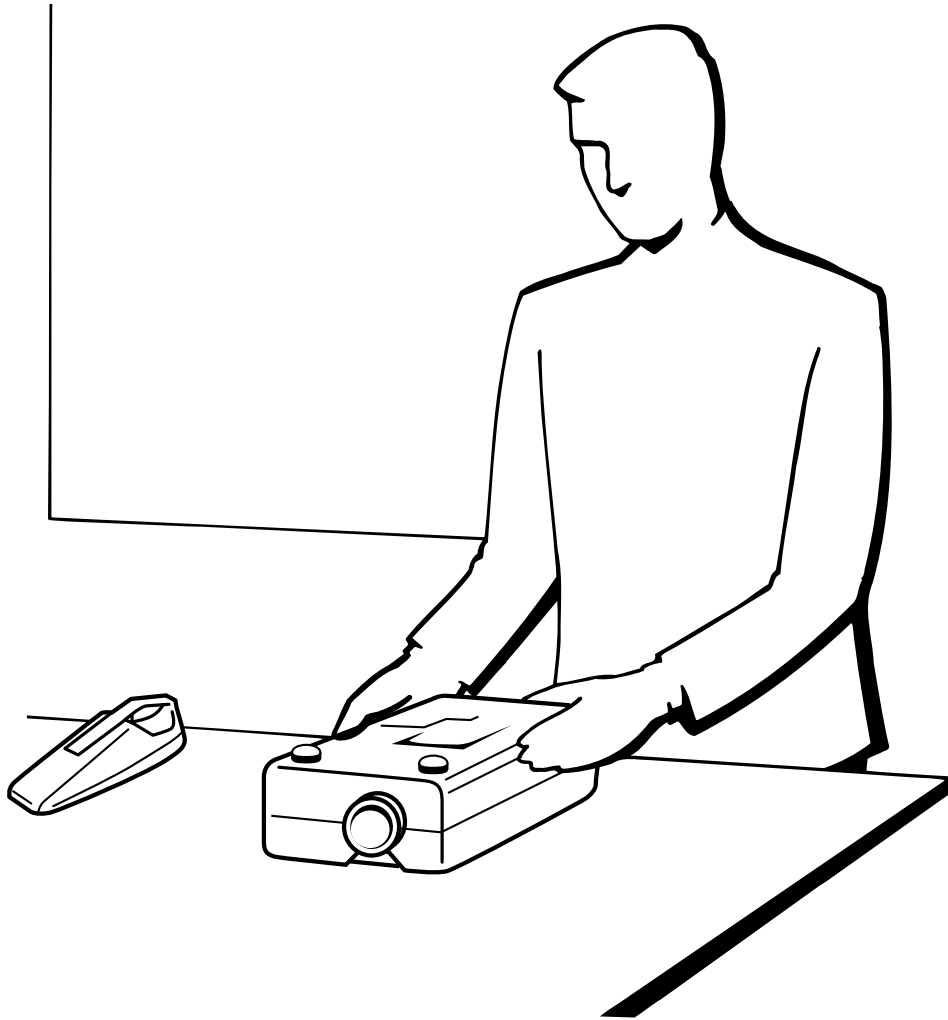



/

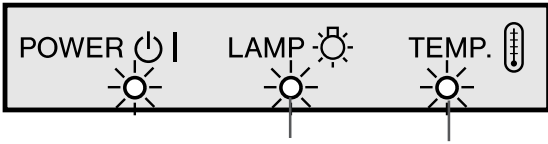

- 가
- 2 가
- 가

			가
	가	가	가 가
		LCD 가 가	
	가	가	LCD 가 가

주

- 5 ) ON/OFF 가 가

LCD (39 ) 가 1,500 . 1,400

주의

주

- 1,500





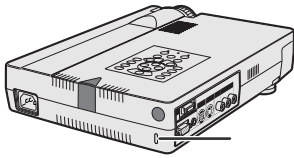

# A/S

가	<ul style="list-style-type: none"> <li>가 (17)</li> <li>(11-15)</li> <li>가 (8)</li> <li>MOUSE/ADJ. 가 MOUSE</li> </ul>
	<ul style="list-style-type: none"> <li>(11-15)</li> <li>(27)</li> <li>(37)</li> </ul>
	<ul style="list-style-type: none"> <li>(27)</li> </ul>
	<ul style="list-style-type: none"> <li>(17 가)</li> <li>(18)</li> </ul>
가	<ul style="list-style-type: none"> <li>(11-15)</li> <li>(17)</li> </ul>
가	<ul style="list-style-type: none"> <li>가</li> </ul>
	<ul style="list-style-type: none"> <li>47 " / "</li> </ul>
IrCOM	<ul style="list-style-type: none"> <li>(25)</li> <li>" A/S "</li> </ul>
가	<ul style="list-style-type: none"> <li>(29)</li> <li>가 RS-232C</li> <li>ON (52-53)</li> </ul>
480P	<ul style="list-style-type: none"> <li>480P (32)</li> </ul>
) (	<ul style="list-style-type: none"> <li>(40)</li> </ul>
가	<ul style="list-style-type: none"> <li>,</li> </ul>



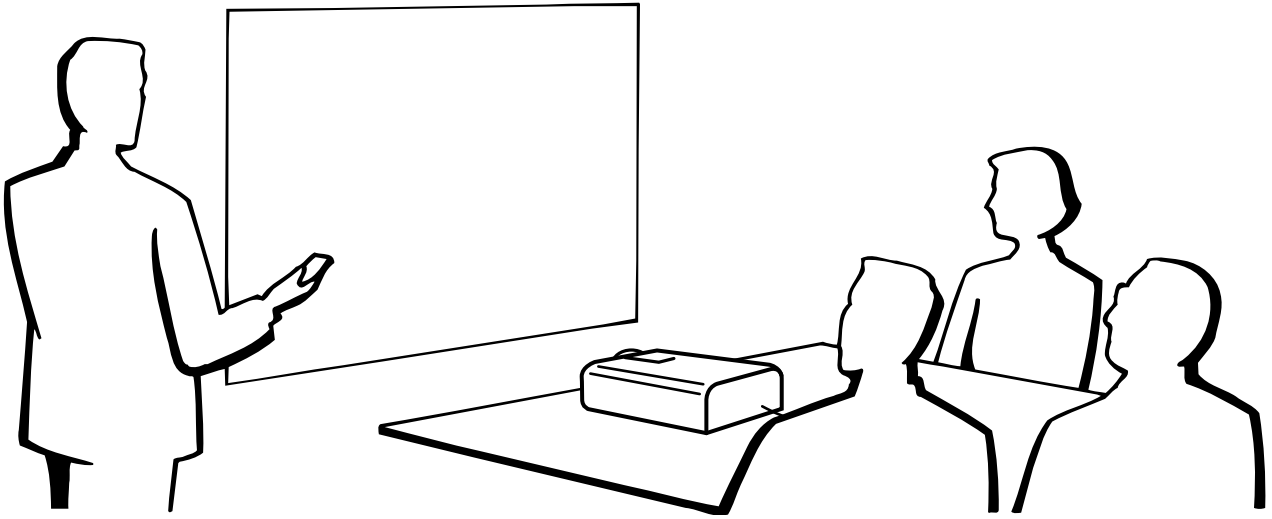



가

가

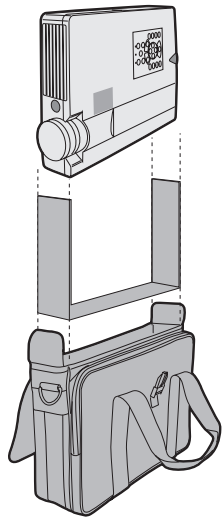

가

⚠ 주의

- 가
- 가
- 가
- 가
- 가

가

가

가

가

가

가

가

가

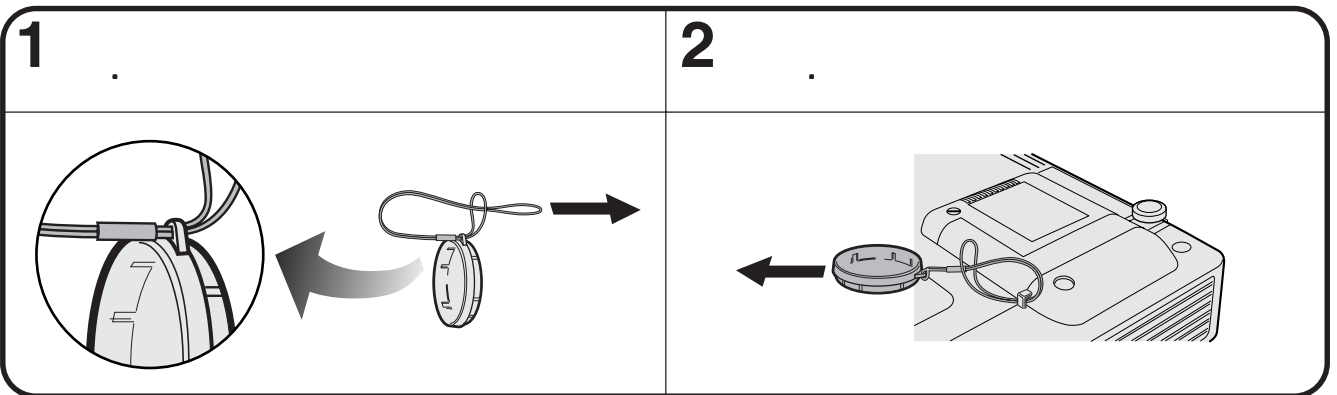
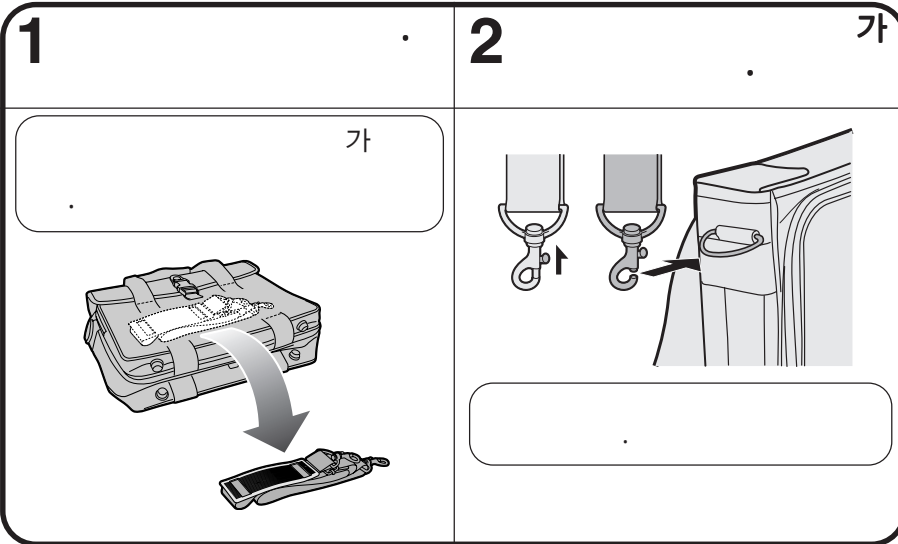

주

•





1 : 15 D-sub

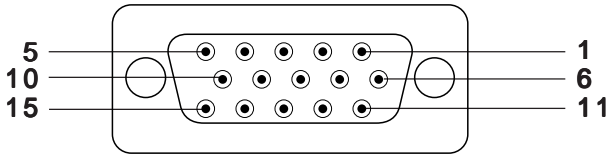

- |    |       |     |                |
|----|-------|-----|----------------|
| 1. | ( )   | 8.  | ( )            |
| 2. | ( / ) | 9.  |                |
| 3. | ( )   | 10. | GND            |
| 4. | 1     | 11. | GND            |
| 5. |       | 12. | Bi-directional |
| 6. | ( )   | 13. |                |
| 7. | ( / ) | 14. |                |
|    | )     | 15. |                |

RS-232C : DIN-D-sub RS-232C 9 D-sub

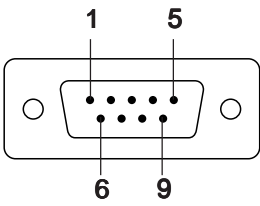

- |   |    |
|---|----|
| 1 | CD |
| 2 | RD |
| 3 | SD |
| 4 | ER |
| 5 | SG |
| 6 | DR |
| 7 | RS |
| 8 | CS |
| 9 | CI |

RS-232C : 9 DIN

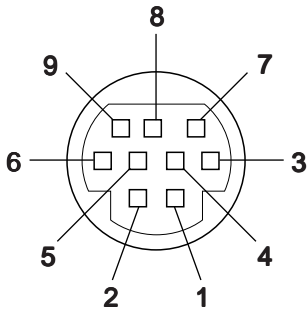

- |   |      |           |
|---|------|-----------|
| 1 | VCC  | +3.3V ( ) |
| 2 | RD   |           |
| 3 | SD   |           |
| 4 | EXIR | ( )       |
| 5 | SG   |           |
| 6 | ERX  | IR ( )    |
| 7 | RS   | IR ( )    |
| 8 | CS   |           |
| 9 | ETX  | IR ( )    |

PanelLink™ : MDR 20

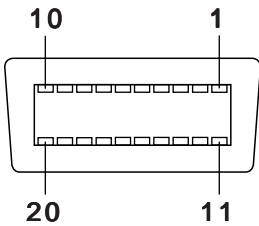

- |    |            |      |
|----|------------|------|
| 1  | RX0-       | (-)  |
| 2  | RX0+       | (+)  |
| 3  | RX0 SHIELD |      |
| 4  | RX2 SHIELD |      |
| 5  | RX2-       | (-)  |
| 6  | RX2+       | (+)  |
| 7  | DC/SCL     | SCL  |
| 8  | DC/SDA     | SDA  |
| 9  | NC         | N.C. |
| 10 | NC         | N.C. |
| 11 | RXC-       | (-)  |
| 12 | RXC+       | (+)  |
| 13 | RXC SHIELD |      |
| 14 | RX1 SHIELD |      |
| 15 | RX1-       | (-)  |
| 16 | RX1+       | (+)  |
| 17 | NC         | N.C. |
| 18 | SENS       | SENS |
| 19 | DDC +5V DC | +5V  |
| 20 | DDC GND    | GND  |



# RS-232C

PC

RS-232C ( , ) . ( 14 )

: RS-232C  
: 9,600 bps  
: 8 bits  
: 1 bit

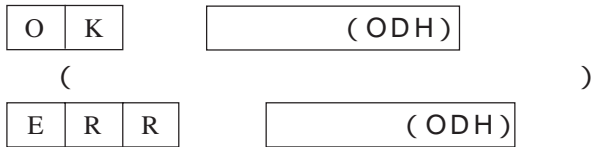
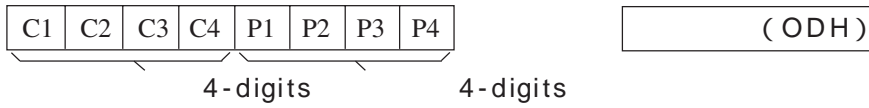

OK

주

가

예

• -10 1 " "

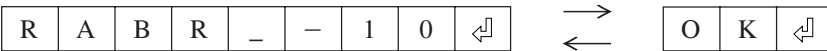

	C1	C2	C3	C4	P1	P2	P3	P4	
OFF	A	P	O	W	_	_	_	0	OFF
	A	P	O	W	_	_	_	1	ON
	P	O	W	R	_	_	_	0	OFF( )
	P	O	W	R	_	_	_	1	ON
	I	V	E	D	_	_	_	1	
	I	R	G	B	_	_	_	1	1
	I	R	G	B	_	_	_	2	2
	I	C	O	M	_	_	_	1	IrCOM
	I	C	H	K	_	_	_	0	
	K	E	Y	S	*	*	*	*	(-127 ~ +127)

	C1	C2	C3	C4	P1	P2	P3	P4	
	M	E	L	A	_	_	_	1	ENGLISH
	M	E	L	A	_	_	_	2	DEUTSCH
	M	E	L	A	_	_	_	3	ESPAÑOL
	M	E	L	A	_	_	_	4	NEDERLANDS
	M	E	L	A	_	_	_	5	FRANÇAIS
	M	E	L	A	_	_	_	6	ITALIANO
	M	E	L	A	_	_	_	7	SVENSKA
	M	E	L	A	_	_	_	8	日本語
	M	E	L	A	_	_	_	9	PORTUGUÉS
	M	E	L	A	_	_	1	0	汉语
	M	E	L	A	_	_	1	1	한국어





	C1	C2	C3	C4	P1	P2	P3	P4		
	M	E	S	Y	_	_	_	1		
	M	E	S	Y	_	_	_	2	PAL (50/60Hz)	
	M	E	S	Y	_	_	_	3	SECAM	
	M	E	S	Y	_	_	_	4	NTSC 4.43	
	M	E	S	Y	_	_	_	5	NTSC 3.58	
	V	A	P	I	_	*	*	*	(-30 ~ +30)	
	V	A	B	R	_	*	*	*	(-30 ~ +30)	
	V	A	C	O	_	*	*	*	(-30 ~ +30)	
	V	A	T	I	_	*	*	*	(-30 ~ +30)	
	V	A	S	H	_	*	*	*	(-30 ~ +30)	
	V	A	R	E	_	_	_	1		
	V	A	R	D	_	*	*	*	(-30 ~ +30)	
	V	A	B	E	_	*	*	*	(-30 ~ +30)	
	V	A	R	E	_	_	_	0		
	V	A	R	E	_	_	_	1		
		I	M	B	G	_	_	_	1	
		I	M	B	G	_	_	_	2	
I		M	B	G	_	_	_	3		
I		M	B	G	_	_	_	4		
	I	M	S	I	_	_	_	1		
	I	M	S	I	_	_	_	2		
	I	M	S	I	_	_	_	3		
	V	O	L	A	_	_	*	*	(00 ~ 60)	
	M	U	T	E	_	_	_	0	OFF	
	M	U	T	E	_	_	_	1	ON	
	A	A	T	E	_	*	*	*	(-30 ~ +30)	
	A	A	B	A	_	*	*	*	(-30 ~ +30)	
	A	A	R	E	_	_	_	0		
	A	A	R	E	_	_	_	1		
1	R	A	P	I	_	*	*	*	(-30 ~ +30)	
	R	A	B	R	_	*	*	*	(-30 ~ +30)	
	R	A	R	D	_	*	*	*	(-30 ~ +30)	
	R	A	B	E	_	*	*	*	(-30 ~ +30)	
	R	A	R	E	_	_	_	0	1	
	R	A	C	O	_	*	*	*	(-30 ~ +30)	
	R	A	T	I	_	*	*	*	(-30 ~ +30)	
	R	A	S	H	_	*	*	*	(-30 ~ +30)	
	R	A	R	E	_	_	_	1		
	2	R	B	P	I	_	*	*	*	(-30 ~ +30)
R		B	B	R	_	*	*	*	(-30 ~ +30)	
R		B	R	D	_	*	*	*	(-30 ~ +30)	
R		B	B	E	_	*	*	*	(-30 ~ +30)	
R		B	R	E	_	_	_	0	2	
R		B	R	E	_	_	_	1		
	A	A	D	J	_	_	_	0	OFF	
	A	A	D	J	_	_	_	1	ON	
	A	D	J	S	_	_	_	1		

	C1	C2	C3	C4	P1	P2	P3	P4		
	I	N	C	L	*	*	*	*	(-150 ~ +150)	
	I	N	P	H	_	*	*	*	(-60 ~ +60)	
	I	A	H	P	*	*	*	*	(-150 ~ +150)	
	I	A	V	P	_	*	*	*	(-60 ~ +60)	
	I	A	R	E	_	_	_	0		
	I	A	R	E	_	_	_	1		
	I	M	D	I	_	_	_	0	OSD OFF	
	I	M	D	I	_	_	_	1	OSD ON	
	I	M	R	E	_	_	_	0	OFF	
	I	M	R	E	_	_	_	1	ON	
	I	M	I	N	_	_	_	0	OFF	
	I	M	I	N	_	_	_	1	ON	
	I	M	A	S	_	_	_	0	OFF	
	I	M	A	S	_	_	_	1	ON	
	I	M	I	P	_	_	_	0	I/P	
	I	M	I	P	_	_	_	1	I/P	
	1	I	A	S	I	_	_	_	1	RGB
		I	A	S	I	_	_	_	2	
	G	A	M	R	_	_	_	1		
	G	A	M	R	_	_	_	2	1	
	G	A	M	R	_	_	_	3	2	
	G	A	M	R	_	_	_	4		
	G	A	M	V	_	_	_	1		
	G	A	M	V	_	_	_	2	1	
	G	A	M	V	_	_	_	3	2	
	G	A	M	V	_	_	_	4		
	S	Y	S	E	_	_	_	0		
	I	M	B	K	_	_	_	0	OFF	
	I	M	B	K	_	_	_	1	ON	
	I	M	B	O	_	_	_	0	OFF	
	I	M	B	O	_	_	_	1	ON	
	M	E	M	S	_	_	_	*	(1~7)	
	M	E	M	L	_	_	_	*	(1~7)	
1	R	A	S	R	_	_	_	1		
	R	A	S	R	_	_	_	2	/	
	R	A	S	R	_	_	_	3		
	R	A	S	R	_	_	_	4	( )	
2	R	B	S	R	_	_	_	1		
	R	B	S	R	_	_	_	2	/	
	R	B	S	R	_	_	_	3		
	R	B	S	R	_	_	_	4	( )	
	R	A	S	V	_	_	_	1		
	R	A	S	V	_	_	_	2		
	R	A	S	V	_	_	_	3		
	N	F	I	L	_	_	_	0	OFF	
	N	F	I	L	_	_	_	1	ON	

주

- ( ) 가
- 가
- 가

- ( \* ) 가
- RS-232C ON



( )

IBM

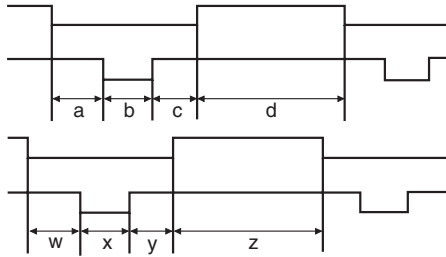

Macintosh

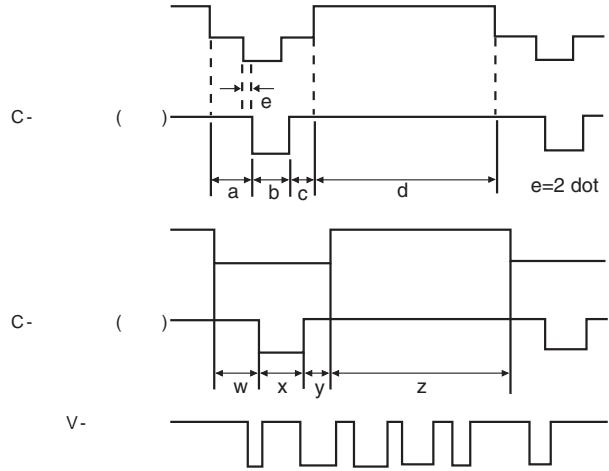

VESA

VESA

1(HD-15)



200Hz

			PORCH		PERIOD		1H		1dot		1/H		PORCH		PERIOD		1V		1/V	
	dot	line	a	b	c	d	(a+b+c+d)	dot	μs	ns	kHz	MHz	w	x	y	z	(w+x+y+z)	ms	Hz	
VGA	VESA	640	350	32	64	96	640	832	26.4	31.7	37.861	31.500	32	3	60	350	445	11.8	85.080	
		640	400	32	64	96	640	832	26.4	31.7	37.861	31.500	1	3	41	400	445	11.8	85.080	
		720	400	36	72	108	720	936	26.4	28.2	37.927	35.500	1	3	42	400	446	11.8	85.039	
	VESA	640	480	8	96	40	640	800	31.8	39.7	31.469	25.175	2	2	25	480	525	16.7	59.940	
		640	480	16	40	120	640	832	26.4	31.7	37.861	31.500	1	3	20	480	520	13.7	72.809	
		640	480	16	64	120	640	840	26.7	31.7	37.500	31.500	1	3	16	480	500	13.3	75.000	
SVGA	VESA	800	600	56	56	80	640	832	23.1	27.8	43.269	36.000	1	3	25	480	509	11.8	85.008	
		800	600	24	72	128	800	1,024	28.4	27.8	35.156	36.000	1	2	22	600	625	17.8	56.250	
		800	600	40	128	88	800	1,056	26.4	25.0	37.879	40.000	1	4	23	600	628	16.6	60.317	
	VESA	800	600	56	120	64	800	1,040	20.8	20.0	48.077	50.000	37	6	23	600	666	13.9	72.188	
		800	600	16	80	160	800	1,056	21.3	20.2	46.875	49.500	1	3	21	600	625	13.3	75.000	
		800	600	32	64	152	800	1,048	18.6	17.8	53.674	56.250	1	3	27	600	631	11.8	85.061	
XGA	VESA	1,024	768	8	176	56	1,024	1,264	28.2	22.3	35.522	44.900	0	4	20	768	817	23.0	43.479	
		1,024	768	24	136	160	1,024	1,344	20.7	15.4	48.363	65.000	3	6	29	768	806	16.7	60.004	
		1,024	768	24	136	144	1,024	1,328	17.7	13.3	56.476	75.000	3	6	29	768	806	14.3	70.069	
	VESA	1,024	768	16	96	176	1,024	1,312	16.7	12.7	60.023	78.750	1	3	28	768	800	13.3	75.029	
		1,024	768	48	96	208	1,024	1,376	14.6	10.6	68.677	94.500	1	3	36	768	808	11.8	84.997	
		1,152	864	64	128	256	1,152	1,600	14.8	9.3	67.500	108.000	1	3	32	864	900	13.3	75.000	
SXGA	VESA	1,280	960	96	112	312	1,280	1,800	16.7	9.3	60.000	108.000	1	3	36	960	1,000	16.7	60.000	
		1,280	960	64	160	224	1,280	1,728	11.6	6.7	85.938	148.500	1	3	47	960	1,011	11.8	85.002	
		1,280	1,024	48	112	248	1,280	1,688	15.6	9.3	63.981	108.000	1	3	38	1,024	1,066	16.7	60.020	
	VESA	1,280	1,024	16	144	248	1,280	1,688	12.5	7.4	79.976	135.000	1	3	38	1,024	1,066	13.3	75.025	
		1,280	1,024	64	160	224	1,280	1,728	11.0	6.3	91.146	157.500	1	3	44	1,024	1,072	11.8	85.024	
		1,280	1,024	64	160	224	1,280	1,728	11.0	6.3	91.146	157.500	1	3	44	1,024	1,072	11.8	85.024	
UXGA	VESA	1,600	1,200	64	192	304	1,600	2,160	13.3	6.2	75.000	162.000	1	3	46	1,200	1,250	16.7	60.000	
		1,600	1,200	64	192	304	1,600	2,160	12.3	5.7	81.250	175.500	1	3	46	1,200	1,250	15.4	65.000	
		1,600	1,200	64	192	304	1,600	2,160	11.4	5.3	87.500	189.000	1	3	46	1,200	1,250	14.3	70.000	
		1,600	1,200	64	192	304	1,600	2,160	10.7	4.9	93.750	202.500	1	3	46	1,200	1,250	13.3	75.000	
		1,600	1,200	64	192	304	1,600	2,160	9.4	4.4	106.250	229.500	1	3	46	1,200	1,250	11.8	85.000	
		1,600	1,200	64	192	304	1,600	2,160	9.4	4.4	106.250	229.500	1	3	46	1,200	1,250	11.8	85.000	



( )

	dot	line	0.7 Vp-p 75 Ω load	R • G • B	PORCH	b	PORCH	PERIOD	1H (a+b+c+d)		1dot	1/H	1/dot	PORCH	x	PORCH	PERIOD	1V (w+x+y+z)		1V		
					a	dot	c	d	dot	μs	ns	kHz	MHz	w	H	y	z	H	ms	Hz		
					dot	dot	dot	dot	dot	dot	dot	dot	dot	H	H	H	H	H	ms	Hz		
Macintosh™	13" Monitor	640	480	R • G • B	64	64	96	640	864	28.6	33.1	35.000	30.2400	3	3	39	480	525	15.0	66.670		
	16" Monitor	832	624		31	65	224	832	1,152	20.1	17.5	49.693	57.246	1	3	39	624	667	13.4	74.502		
	19" Monitor	1,024	768		35	96	173	1,024	1,328	16.7	12.5	60.000	79.760	3	3	30	768	804	13.4	74.700		
	21" Monitor	1,152	870		36	128	140	1,152	1,456	14.5	10.0	68.887	100.300	3	3	39	870	915	13.3	75.287		
SUN	66Hz	1,152	900		R • G • B	29	128	195	1,152	1,504	14.8	10.8	61.795	92.940	2	4	31	900	937	14.3	69.950	
	76Hz	1,152	900			16	96	208	1,152	1,472	13.9	9.5	71.713	105.561	2	8	33	900	943	13.1	76.048	
	84Hz	1,152	900			24	96	168	1,024	1,312	14.1	10.8	70.838	92.940	2	8	33	800	843	11.9	84.031	
DTV	480I	640	480			R • G • B	-	-	-	-	-	-	-	15.734	-	-	-	-	-	-	-	59.940
	480P	640	480				-	-	-	-	-	-	-	-	31.469	-	-	-	-	-	-	59.940
	720P	1,280	720				-	-	-	-	-	-	-	-	44.955	-	-	-	-	-	-	59.740
	1080I	1,920	1,080				-	-	-	-	-	-	-	-	33.716	-	-	-	-	-	-	59.940

주 (CRT/LCD) 가  
 • LCD "CRT" (CRT only)  
 • 640 × 350 VESA VGA "640 × 400"  
 • 1,600 × 1,200 VESA UXGA sampling 1,024

2( )



• 108MHz 2 (Panel Link)

	dot	line	0.7 Vp-p 75 Ω load	R • G • B	PORCH	b	PORCH	PERIOD	1H (a+b+c+d)		1dot	1/H	1/dot	PORCH	x	PORCH	PERIOD	1V (w+x+y+z)		1V
					a	dot	c	d	dot	μs	ns	kHz	MHz	w	H	y	z	H	ms	Hz
					dot	dot	dot	dot	dot	dot	dot	dot	dot	H	H	H	H	H	ms	Hz
VGA	VESA	640	350	R • G • B	32	64	96	640	832	26.4	31.7	37.861	31.500	32	3	60	350	445	11.8	85.080
		640	400		32	64	96	640	832	26.4	31.7	37.861	31.500	1	3	41	400	445	11.8	85.080
		720	400		36	72	108	720	936	26.4	28.2	37.927	35.500	1	3	42	400	446	11.8	85.039
	VESA	640	480		8	96	40	640	800	31.8	39.7	31.469	25.175	2	2	25	480	525	16.7	59.940
		640	480		16	40	120	640	832	26.4	31.7	37.861	31.500	1	3	20	480	520	13.7	72.809
		640	480		16	64	120	640	840	26.7	31.7	37.500	31.500	1	3	16	480	500	13.3	75.000
SVGA	VESA	800	600		56	56	80	640	832	23.1	27.8	43.269	36.000	1	3	25	480	509	11.8	85.008
		800	600		24	72	128	800	1,024	28.4	27.8	35.156	36.000	1	2	22	600	625	17.8	56.250
	VESA	800	600		40	128	88	800	1,056	26.4	25.0	37.879	40.000	1	4	23	600	628	16.6	60.317
		800	600		56	120	64	800	1,040	20.8	20.0	48.077	50.000	37	6	23	600	666	13.9	72.188
XGA	VESA	1,024	768		16	80	160	800	1,056	21.3	20.2	46.875	49.500	1	3	21	600	625	13.3	75.000
		1,024	768		32	64	152	800	1,048	18.6	17.8	53.674	56.250	1	3	27	600	631	11.8	85.061
		1,024	768		8	176	56	1,024	1,264	28.2	22.3	35.522	44.900	0	4	20	768	817	23.0	43.479
	VESA	1,024	768		24	136	160	1,024	1,344	20.7	15.4	48.363	65.000	3	6	29	768	806	16.7	60.004
		1,024	768		24	136	144	1,024	1,328	17.7	13.3	56.476	75.000	3	6	29	768	806	14.3	70.069
		1,024	768		16	96	176	1,024	1,312	16.7	12.7	60.023	78.750	1	3	28	768	800	13.3	75.029
SXGA	VESA	1,152	864		48	96	208	1,024	1,376	14.6	10.6	68.677	94.500	1	3	36	768	808	11.8	84.997
		1,280	960		64	128	256	1,152	1,600	14.8	9.3	67.500	108.000	1	3	32	864	900	13.3	75.000
		1,280	1,024	96	112	312	1,280	1,800	16.7	9.3	60.000	108.000	1	3	36	960	1,000	16.7	60.000	
					48	112	248	1,280	1,688	15.6	9.3	63.981	108.000	1	3	38	1,024	1,066	16.7	60.020





XG-NV7XM  
 PAL/SECAM/NTSC3.58/NTSC4.43/DTV 480P/DTV 720P/DTV 1080I  
 (Digital Micromirror Device™)

(DMD™)  
 DMD : 21.8mm(<sup>55</sup>/<sub>64</sub>" ), 1 XGA DMD  
 : 786,432 dots( 1,024 [H] × 768 [V])  
 1-1.2 × , F2.7-3.0, f=35-42mm  
 P-VIP , AC 120W  
 500:1  
 RCA : , 1.0Vp-p, 가 , 75Ω  
 RCA : , 0.5Vrms, 22kΩ ( )  
 S- 4 DIN  
 Y ( ) : 1.0 Vp-p, 가 , 75Ω  
 C ( ) : 0.286Vp-p, 75Ω  
 20 (INPUT 2):  
 TMDS/PanelLink  
 520TV ( ), 750TV (DTV 720P , )  
 2W ( )  
 RGB 15 D-sub (INPUT 1) :  
 RGB / / : 0-  
 0.7Vp-p, , 75Ω  
 : 0.5Vrms, 22kΩ ( )  
 : TTL ( / 가 ) ( )  
 )  
 :  
 12—230 MHz  
 43—200 Hz  
 15—126 kHz  
 9 DIN (RS-232C )  
 1 <sup>37</sup>/<sub>64</sub>" × 1 <sup>3</sup>/<sub>16</sub>" (4 × 3 cm)  
 AC 110—120/220—240V  
 1.0A/1.9A  
 50/60Hz  
 197W  
 +5°C +35°C  
 -10°C +60°C  
 I/R 38kHz  
 : 650nm/ . : 1mW/Class II  
 ( ) 235 × 58 × 312.5 mm (W× H × D)( )  
 ( ) 235 × 82 × 321.8 mm (W× H × D)( )  
 ( ) 2.85 kg  
 , AA 2 , (3.6m) , (3m) ,  
 (3m) , (1m) , IBM PS/2  
 (1m) , Mac (17cm) , DIN-D-sub RS-232C  
 (15cm) , , 가 , ( ) , , CD-  
 ROM , , , , IrDA  
 (RRMCG1531CESA) , AA  
 (QCNW-5304CEZZ) , (QCNW-4870CEZZ) ,  
 (QCNW-5112CEZZ) , IBM PS/2  
 (QCNW-5113CEZZ) , Mac (QCNW-  
 5114CEZZ) , DIN-D-sub RS-232C (QCNW-5288CEZZ) ,  
 (RUNTK0661CEZZ) , 가 (GCASN0003CESA) ,  
 (GCOVH1308CESA) , (UBNDT0012CEZZ) ,  
 CD-ROM (UDSKA0017CE01) , (TINS-  
 6911CEZZ) , (TINS-6913CEZZ) ,  
 (TINS-6912CEZZ) ,  
 (TINS-6914CEZZ) , IrDA  
 (TCAUZ3051CEZZ) .

786,432

DMD

가



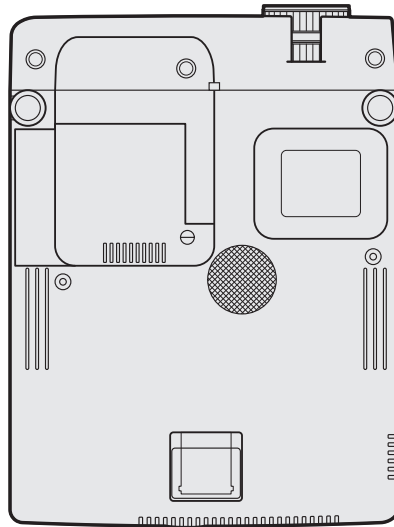
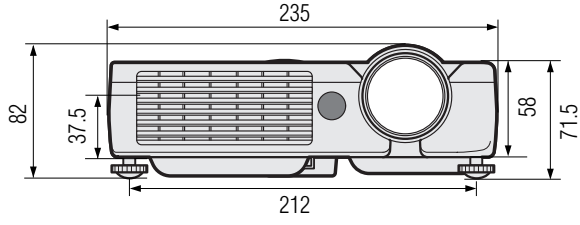
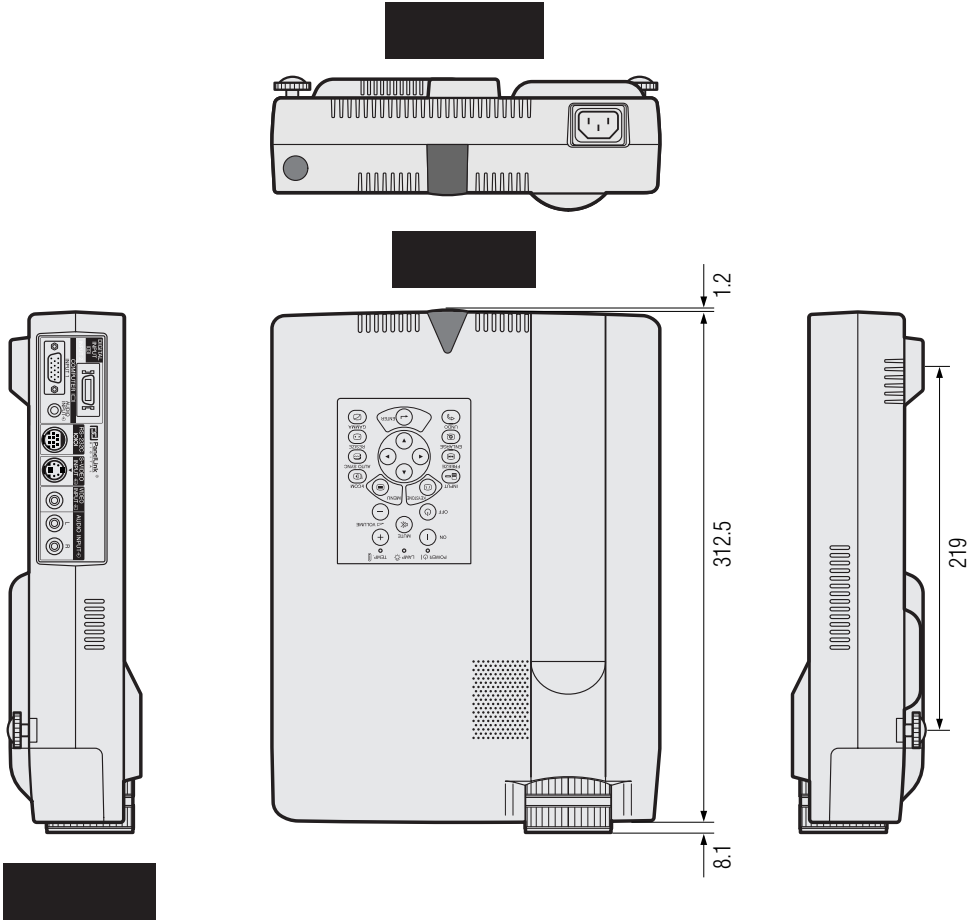

: mm



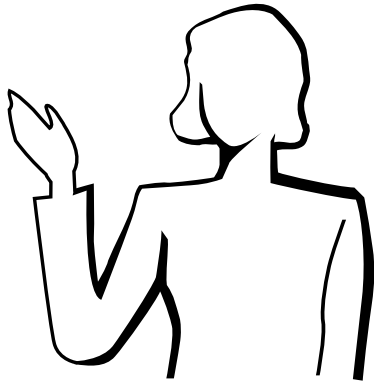

가

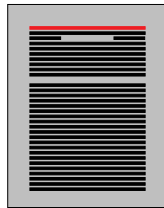
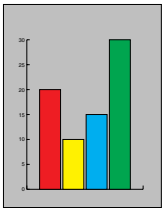

a.

- Astound®, Freelance®, Persuasion®, PowerPoint®, Director®
  - Macromedia
- 주
- Astound®, Freelance®, Persuasion®, PowerPoint®, Macromedia Director®

VCR, DVD

(PDAs)

가

PDAs가

PDA

IrDA / IrTran-P

b.

가

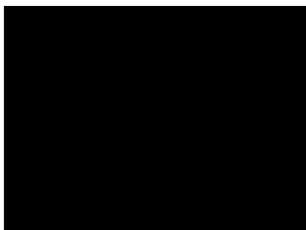

...

가

가

(

)



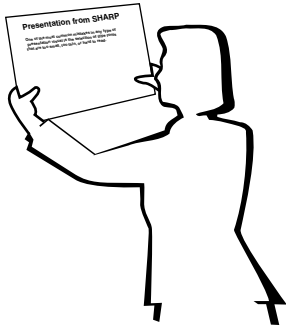

# Sans-serif

# Serif

•

— 가 가

•

•

• 가 가

• 가 가

• 가 가

• 가

•

15cm × 20cm  
300 600 dpi

1.2m 3m  
6.1m, 3.7m , 2.3m 9.1m

가

•

• 가

• /

• 가 가 가 가

• 가 가





d.

• ,가 가

• 100  
가

• , ,

• AC

• 가

e.

• 3

• 가

• 가 가

• 가 15 .1 20

가 “ “ ” ”





PC

가

**DMD**

(Digital Micromirror Device™) (DMD™)

가

**I/P**

“ ” “ ”

**IrCOM**

“ ”

PC

**IrDA**

**IrTran-P**

( )

**RS-232C**

RS-232C

**GUI**

Graphical User Interface,

가

**PDF**

CD-ROM

4:3.16:9 21:9

가

4:3

4:3





⌘	( GAMMA ) .....	35	IrCOM .....	25
⌘	( ) .....	51	IrCOM .....	25
⌘	( ) .....	5	IrDA .....	58
⌘	.....	19	IrTran-P.....	58
⌘	.....	19	RS-232C .....	14
DIN-D-sub RS-232C	.....	14	S- .....	13
⌘	.....	21	⌘	.....
⌘	.....	21	.....	38
⌘	.....	47	.....	30
⌘	( LASER ) .....	22	( AUTO SYNC ) .....	29
⌘	.....	50	.....	16
⌘	.....	50	.....	16
⌘	/ ( MOUSE / ADJ . ) .....	21	.....	11
⌘	.....	22	.....	23
⌘	.....	15	GUI ( Graphical User Interface ) .....	23
⌘	.....	21	⌘	.....
⌘	.....	21	.....	20
⌘	( MENU ) .....	23	⌘	.....
Mac	.....	15	1 .....	11
⌘	.....	43	2 .....	12
⌘	( BLACK SCREEN ) .....	37	.....	11
⌘	.....	13	( KEYSTONE ) .....	19
⌘	.....	41	.....	48
⌘	( LIGHT ) .....	22	⌘	.....
⌘	.....	45	⌘	.....
⌘	( SAPS ) .....	25	⌘	.....
⌘	.....	29	⌘	.....
⌘	.....	29	⌘	.....
⌘	.....	42	⌘	.....
⌘	.....	40	⌘	.....
⌘	.....	40	⌘	.....
⌘	.....	36	⌘	.....
⌘	( ENTER ) .....	23	⌘	.....
⌘	.....	13	⌘	.....
⌘	.....	11	⌘	.....
⌘	.....	28	⌘	.....
⌘	( R-CLICK ) .....	22	⌘	.....
⌘	.....	47	⌘	.....
⌘	( L-CLICK ) .....	22	⌘	.....
가	.....	50	⌘	.....
⌘	( MUTE ) .....	17	⌘	.....
⌘	( FREEZE ) .....	33	⌘	.....
⌘	( INPUT ) .....	17	⌘	.....
AC	.....	11	⌘	.....
Auto Sync	.....	30	⌘	.....
I/P	.....	39	⌘	.....
IBM PS/2	.....	15	⌘	.....
IrCOM	.....	25	⌘	.....





# **SHARP CORPORATION**

OSAKA, JAPAN